

FREEWAY DIVERSION	POTTAWATTAMIE COUNTY IOWA	I-80 WESTBOUND	FROM: Exit 29 (335th St)	TO: System Interchange	PLAN 2604 1/7
------------------------------	--------------------------------------	-----------------------	-------------------------------------	-----------------------------------	--------------------------

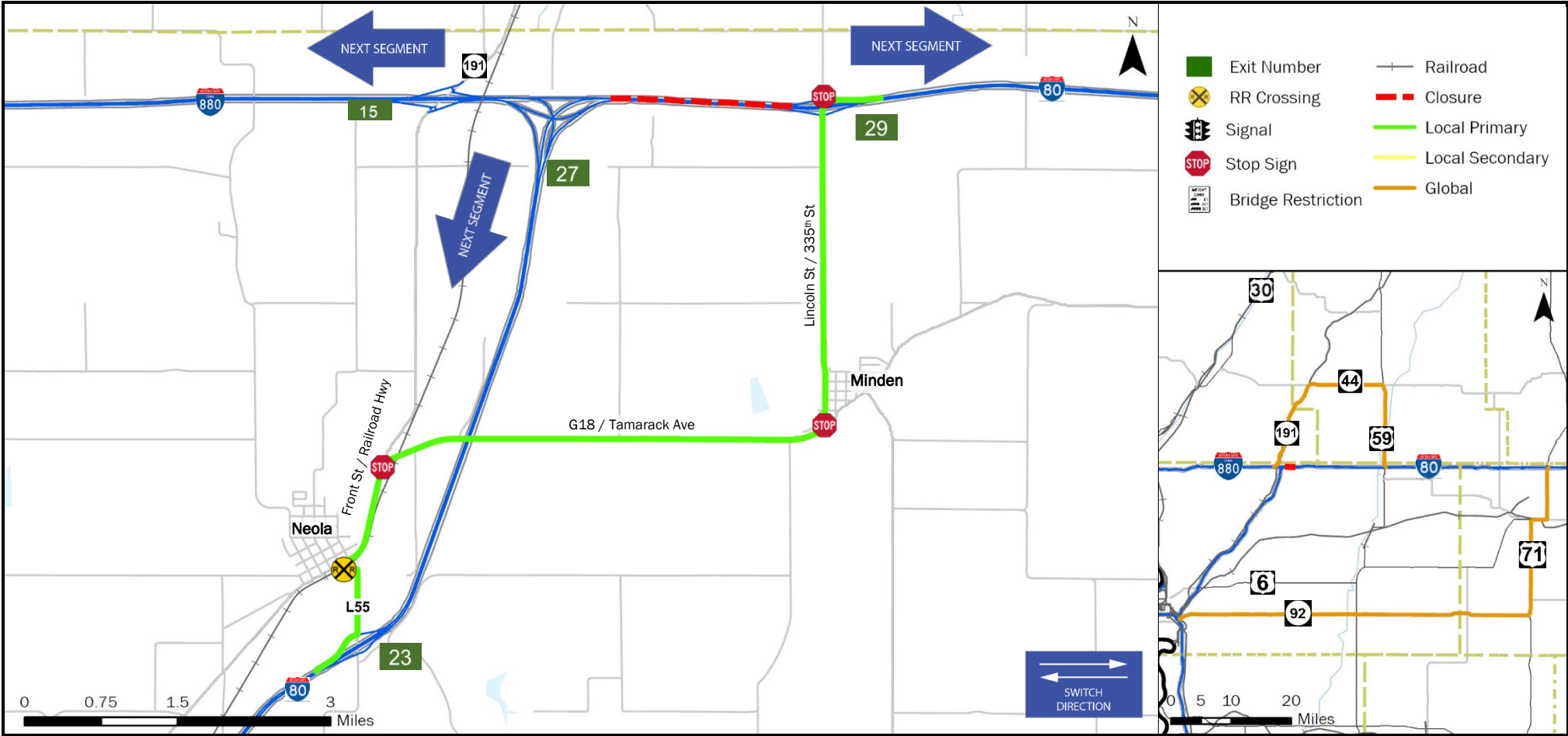

CRITICAL LOCATIONS TO MONITOR FOR LOCAL PRIMARY	AGENCIES TO NOTIFY	Iowa DOT TMC: 515-237-3300
I-80 WB Off Ramp to 335th St SB 335th St SB to G18 WB G18 WB to Railroad Highway SB Railroad Highway SB to L55 SB L55 SB at BNSF RR Crossing (Neola) L55 SB to I-80 WB	Pottawattamie County Emergency Communications Center Iowa DOT Statewide TMC Iowa State Patrol Comm. Center Shelby County Emergency Communications Center BNSF Railway Co.	712-328-5739 515-237-3300 800-525-5555 712-755-5160 800-832-5452

LOCAL DETOUR 1/7	GLOBAL DETOUR 2/7	CRITICAL LOCATIONS 3/7	RESPONSE PLAN 4/7	AGENCY CONTACTS 5/7	DMS MESSAGES 6/7	TRAFFIC CONTROL 7/7
---------------------------------	----------------------------------	---------------------------------------	----------------------------------	------------------------------------	---------------------------------	------------------------------------

FREEWAY DIVERSION	POTTAWATTAMIE COUNTY IOWA	I-80 WESTBOUND	FROM: Exit 29 (335th St)	TO: System Interchange	PLAN 2604 2/7
------------------------------	--------------------------------------	-----------------------	------------------------------------	----------------------------------	--------------------------------

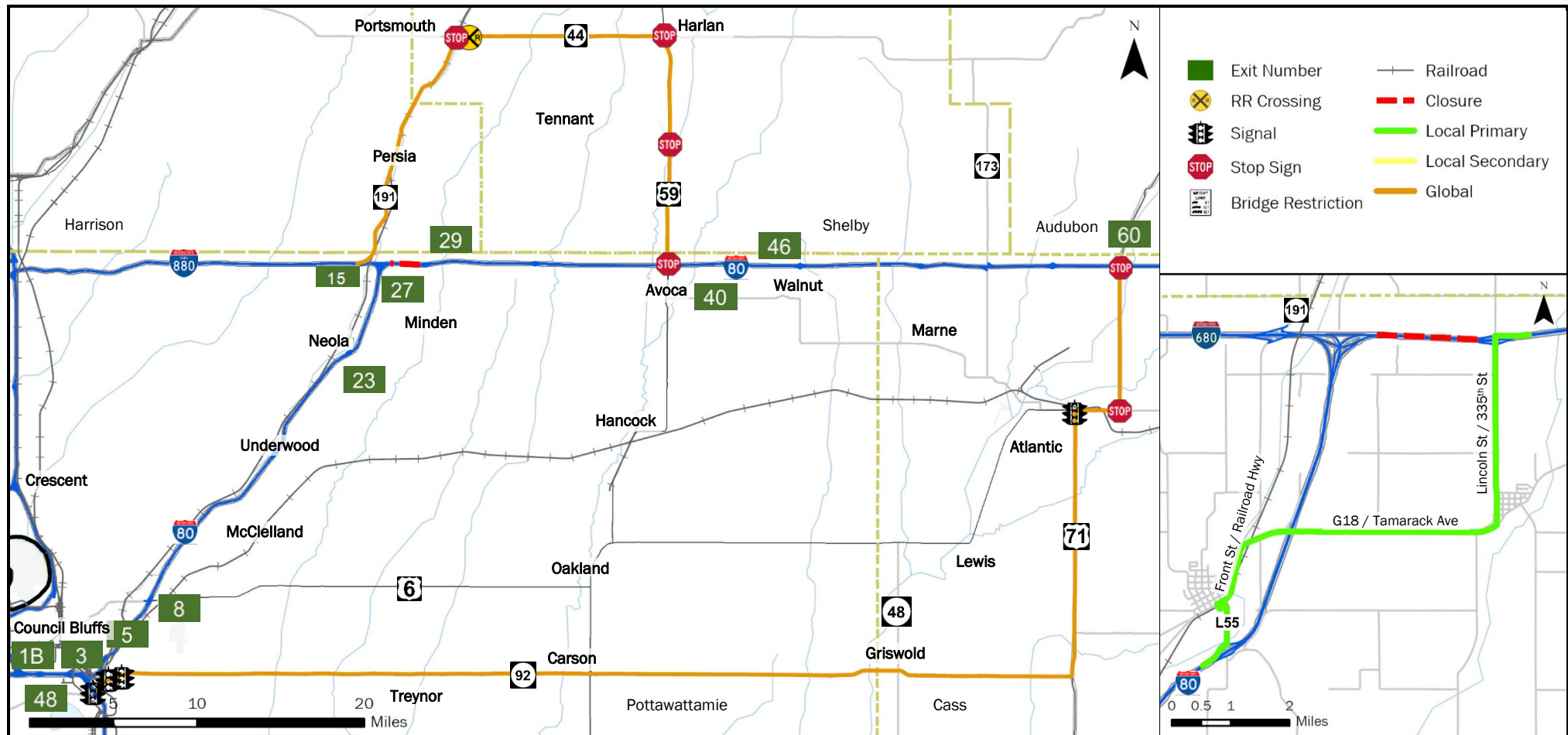

CRITICAL LOCATIONS TO MONITOR FOR GLOBAL	AGENCIES TO NOTIFY
I-80 WB Off Ramp to US 59 NB	Pottawattamie County Emergency Communications Center 712-328-5739
US 59 NB to IA 44 WB	Iowa DOT Statewide TMC 515-237-3300
IA 44 WB at BNSF RR Crossing (Portsmouth)	Iowa State Patrol Comm. Center 800-525-5555
IA 44 WB to IA 191 SB	Shelby County Emergency Communications Center 712-755-5160
IA 191 SB to I-880	BNSF Railway Co. 800-832-5452

LOCAL DETOUR 1/7	GLOBAL DETOUR 2/7	CRITICAL LOCATIONS 3/7	RESPONSE PLAN 4/7	AGENCY CONTACTS 5/7	DMS MESSAGES 6/7	TRAFFIC CONTROL 7/7
---------------------------------	----------------------------------	---------------------------------------	----------------------------------	------------------------------------	---------------------------------	------------------------------------

Iowa DOT TMC: 515-237-3300

ENSURE ALL OVERWEIGHT AND OVERSIZE VEHICLES ARE PARKED SAFELY

FREEWAY DIVERSION	POTTAWATTAMIE COUNTY IOWA	I-80 WESTBOUND	FROM: Exit 29 (335th St) TO: System Interchange	PLAN 2604 3/7
CRITICAL AREAS TO MONITOR				

LOCATION	EXIT	SITUATION	RESPONSE
-----------------	-------------	------------------	-----------------

Local Diversion - Primary

I-80 WB Off Ramp to 335th St SB	29	Traffic backing up onto interstate	Provide appropriate message on upstream DMS
335th St SB to G18 WB		Traffic backing up and significant delays due to stop sign	Notify local law enforcement
G18 WB to Railroad Highway SB		Traffic backing up and significant delays due to stop sign	Notify local law enforcement
Railroad Highway SB to L55 SB		Traffic backing up and significant delays due to left turn	Notify local law enforcement
L55 SB at BNSF RR Crossing (Neola)		Train blocking the crossing (Flashers)	Contact BNSF Railroad and notify local law enforcement
L55 SB to I-80 WB	23	Traffic returning to interstate	Monitor location

Local Diversion - Secondary

--

Global Diversion

I-80 WB Off Ramp to US 59 NB	40	Traffic backing up onto interstate	Provide appropriate message on upstream DMS
US 59 NB to IA 44 WB		Traffic backing up and delays due to stop sign and left turn	Notify local law enforcement
IA 44 WB at BNSF RR Crossing (Portsmouth)		Train blocking the crossing (Gates/Flashers)	Contact BNSF Railroad and notify local law enforcement
IA 44 WB to IA 191 SB		Traffic backing up and delays due to stop sign and left turn	Notify local law enforcement
IA 191 SB to I-880	28	Traffic returning to interstate	Monitor location

LOCAL DETOUR 1/7	GLOBAL DETOUR 2/7	CRITICAL LOCATIONS 3/7	RESPONSE PLAN 4/7	AGENCY CONTACTS 5/7	DMS MESSAGES 6/7	TRAFFIC CONTROL 7/7
---------------------------------	----------------------------------	---------------------------------------	----------------------------------	------------------------------------	---------------------------------	------------------------------------

FREEWAY DIVERSION	POTTAWATTAMIE COUNTY IOWA	I-80 WESTBOUND	FROM: Exit 29 (335th St) TO: System Interchange	PLAN 2604 4/7
ALTERNATE ROUTE RESPONSE PLAN				

Minor Impact to Traffic (Less Than 30 Minutes)

Off Peak – Shoulder Blocked	Diversion not implemented: <ul style="list-style-type: none"> • On-scene traffic control • Deploy informational DMS messaging for approaching traffic
Off Peak – Shoulder and One Lane Blocked	

Intermediate Impact to Traffic (30 Minutes to 2 Hours)

Peak Period – Shoulder Blocked	Diversion not implemented: <ul style="list-style-type: none"> • On-scene traffic control • Deploy informational DMS messaging for approaching traffic
Off Period – Shoulder and One Lane Blocked	
Peak Period – Shoulder and One Lane Blocked	Partial Diversion: <ul style="list-style-type: none"> • On-scene traffic control • Deploy informational DMS messaging for approaching traffic • Deploy DMS messaging directing through traffic to use diversion routes • Monitor local diversion routes at critical locations as needed
All Lanes Blocked	Full Diversion: <ul style="list-style-type: none"> • On-scene traffic control • Deploy DMS messaging directing all traffic to use diversion routes • Deploy law enforcement to direct traffic at critical locations

Major Impact to Traffic (Greater Than 2 Hours)

Peak Period – Shoulder Blocked	Diversion not implemented: <ul style="list-style-type: none"> • On-scene traffic control • Deploy informational DMS messaging for approaching traffic
Off Period – Shoulder and One Lane Blocked	
Peak Period – Shoulder and One Lane Blocked	Partial/Discretionary Diversion: <ul style="list-style-type: none"> • Deploy cones, barricades, and other appropriate traffic control devices • Deploy informational DMS messaging for approaching traffic • Deploy DMS messaging directing through traffic to use diversion routes • Divert traffic to local diversion routes at discretion of incident commander
All Lanes Blocked	Full Diversion: <ul style="list-style-type: none"> • Deploy cones, barricades, and other appropriate traffic control devices • Deploy DMS messaging directing all traffic to use diversion routes • Deploy law enforcement to direct traffic at critical locations

LOCAL DETOUR 1/7	GLOBAL DETOUR 2/7	CRITICAL LOCATIONS 3/7	RESPONSE PLAN 4/7	AGENCY CONTACTS 5/7	DMS MESSAGES 6/7	TRAFFIC CONTROL 7/7
---------------------------------	----------------------------------	---------------------------------------	----------------------------------	------------------------------------	---------------------------------	------------------------------------

FREEWAY DIVERSION	POTTAWATTAMIE COUNTY IOWA	I-80 WESTBOUND	FROM: Exit 29 (335th St) TO: System Interchange	PLAN 2604 5A/7
------------------------------	--------------------------------------	-----------------------	--	---------------------------

CRITICAL CONTACTS

Pottawattamie County Emergency Communications Center 712-328-5739	Iowa DOT Statewide TMC 515-237-3300	Iowa State Patrol Comm. Center 800-525-5555	Shelby County Emergency Communications Center 712-755-5160	BNSF Railway Co. 800-832-5452
---	---	---	--	---

RESPONSIBILITIES

Pottawattamie County Emergency Communications Center	712-328-5739
Coordinate with the incident commander as to whether a diversion route is needed and which one should be implemented. <ul style="list-style-type: none"> Notify Iowa DOT statewide TMC of route implemented, incident specific or maintenance needs, and who the incident commander is. Dispatch County Sheriff, local law enforcement, and fire departments as needed. Inform local municipalities and other jurisdictions that a diversion route is being implemented. Deploy law enforcement to direct traffic at critical locations as needed. 	
<u>Emergency Responders:</u> <ul style="list-style-type: none"> Secure scene. Provide incident information, diversion route recommendations, and towing needs to E911. Minimize impact to traffic. Ensure overweight and oversize vehicles are parked. Provide manual traffic control as needed, or as directed by E911 at critical locations. 	

Iowa DOT Statewide TMC	515-237-3300
Deploy informational DMS and 511 messages to alert motorists of construction, delays, incidents, closures, etc. and/or directional DMS messaging to direct traffic to the implemented diversion route. <ul style="list-style-type: none"> Monitor incidents and critical locations along the implemented diversion route. Coordinate with Iowa DOT maintenance facilities regarding traffic control needs. Deploy PDMS and Portable CCTV devices as needed for longer duration incidents. Coordinate with local municipalities regarding the modification of signals, signal timing, or stop signs. Coordinate with railroad authority regarding key crossings along the implemented diversion route. 	

Iowa State Patrol Comm. Center	800-525-5555
Dispatch State Patrol.	
<u>On-Scene Incident Commander:</u> <ul style="list-style-type: none"> Secure scene. Notify appropriate communications center of incident location, anticipated duration, affected lanes, and identify the incident commander. Coordinate with the communications center regarding diversion route needs. Minimize impact to traffic through coordination of on-scene traffic control. Ensure overweight and oversize vehicles are parked. When the incident is safely cleared, notify the appropriate communications center that the diversion route is no longer needed. 	

LOCAL DETOUR 1/7	GLOBAL DETOUR 2/7	CRITICAL LOCATIONS 3/7	RESPONSE PLAN 4/7	AGENCY CONTACTS 5/7	DMS MESSAGES 6/7	TRAFFIC CONTROL 7/7
--------------------------------	---------------------------------	--------------------------------------	---------------------------------	-----------------------------------	--------------------------------	-----------------------------------

Iowa DOT TMC: 515-237-3300

ENSURE ALL OVERWEIGHT AND OVERSIZE VEHICLES ARE PARKED SAFELY

FREEWAY DIVERSION	POTTAWATTAMIE COUNTY IOWA	I-80 WESTBOUND	FROM: Exit 29 (335th St) TO: System Interchange	PLAN 2604 5A/7
CRITICAL CONTACTS				

Shelby County Emergency Communications Center	712-755-5160
Inform emergency responders and local municipalities that a diversion route is being implemented. <ul style="list-style-type: none"> • Monitor critical locations. • Provide manual traffic control as needed, or as directed by E911 at critical locations. • Notify Iowa DOT statewide TMC of any issues along the implemented diversion route. • Coordinate with Iowa DOT statewide TMC regarding any maintenance or traffic control needs. 	

LOCAL DETOUR 1/7	GLOBAL DETOUR 2/7	CRITICAL LOCATIONS 3/7	RESPONSE PLAN 4/7	AGENCY CONTACTS 5/7	DMS MESSAGES 6/7	TRAFFIC CONTROL 7/7
---------------------------------	----------------------------------	---------------------------------------	----------------------------------	------------------------------------	---------------------------------	------------------------------------

FREEWAY DIVERSION	POTTAWATTAMIE COUNTY IOWA	I-80 WESTBOUND	FROM: Exit 29 (335th St) TO: System Interchange	PLAN 2604 5B/7
ADDITIONAL CONTACT INFORMATION				

Pottawattamie County Emergency Communications Center	
Pottawattamie County Sheriff	712-890-2200
Pottawattamie County Emergency Mgmt	712-328-5777
Pottawattamie County Secondary Roads	712-328-5608

Iowa DOT Statewide TMC	
Iowa DOT Statewide TMC (Toll Free)	888-449-9672
Iowa DOT Maint. Garage – Neola	712-485-2591
Iowa DOT Maint. Garage – Avoca	712-343-2655
BNSF Railway Co.	800-832-5452

Iowa State Patrol Comm. Center	
Iowa State Patrol – District 3	712-328-8001
Iowa State Patrol – District 4	712-263-4621

Shelby County Emergency Communications Center	
Shelby County Sheriff	712-755-5026
Shelby County Emergency Mgmt	712-755-2124
Shelby County Secondary Roads	712-755-5954

LOCAL DETOUR 1/7	GLOBAL DETOUR 2/7	CRITICAL LOCATIONS 3/7	RESPONSE PLAN 4/7	AGENCY CONTACTS 5/7	DMS MESSAGES 6/7	TRAFFIC CONTROL 7/7
---------------------------------	----------------------------------	---------------------------------------	----------------------------------	------------------------------------	---------------------------------	------------------------------------

Iowa DOT TMC: 515-237-3300

ENSURE ALL OVERWEIGHT AND OVERSIZE VEHICLES ARE PARKED SAFELY

FREEWAY DIVERSION	POTTAWATTAMIE COUNTY IOWA	I-80 WESTBOUND	FROM: Exit 29 (335th St) T0: System Interchange	PLAN 2604 6/7
DMS MESSAGES				

LOCAL PRIMARY	Sign Location
	NO DMS AVAILABLE

LOCAL SECONDARY	Sign Location	Page 1	Page 2
	NO DMS AVAILABLE		

GLOBAL	Sign Location	Page 1	Page 2
	I-80 WB @ Alice Road - OH	I-80 W CLOSED EXIT 27	USE EXIT 40 US 59 N

LOCAL DETOUR 1/7	GLOBAL DETOUR 2/7	CRITICAL LOCATIONS 3/7	RESPONSE PLAN 4/7	AGENCY CONTACTS 5/7	DMS MESSAGES 6/7	TRAFFIC CONTROL 7/7
--------------------------------	---------------------------------	--------------------------------------	---------------------------------	-----------------------------------	--------------------------------	-----------------------------------

FREEWAY DIVERSION	POTTAWATTAMIE COUNTY IOWA	I-80 WESTBOUND	FROM: Exit 29 (335th St) TO: System Interchange	PLAN 2604 7/7
TRAFFIC CONTROL				

LOCATION	INITIAL ACTION/RESOURCE	EXTENDED ACTION/RESOURCE
----------	-------------------------	--------------------------

Local Diversion - Primary

I-80 WB Off Ramp to 335th St SB	Detour signing	Monitor location
335th St SB to G18 WB	Detour signing	Manual traffic control (as needed/peak periods)
G18 WB to Railroad Highway SB	Detour signing	Manual traffic control (as needed/peak periods)
Railroad Highway SB to L55 SB	Detour signing	Manual traffic control (as needed/peak periods)
L55 SB at BNSF RR Crossing (Neola)	Monitor location Coordinate with local law enforcement as necessary	Coordinate with BNSF Railway and local law enforcement as necessary
L55 SB to I-80 WB	Monitor location	Monitor location

Local Diversion - Secondary

NO LOCAL SECONDARY AVAILABLE

Global Diversion

I-80 WB Off Ramp to US 59 NB	Detour signing	Monitor location
US 59 NB to IA 44 WB	Detour signing	Manual traffic control (as needed/peak periods)
IA 44 WB at BNSF RR Crossing (Portsmouth)	Monitor location Coordinate with local law enforcement as necessary	Coordinate with BNSF Railway and local law enforcement as necessary
IA 44 WB to IA 191 SB	Detour signing	Manual traffic control (as needed/peak periods)
IA 191 SB to I-880	Monitor location	Monitor location

LOCAL DETOUR 1/7	GLOBAL DETOUR 2/7	CRITICAL LOCATIONS 3/7	RESPONSE PLAN 4/7	AGENCY CONTACTS 5/7	DMS MESSAGES 6/7	TRAFFIC CONTROL 7/7
---------------------------------	----------------------------------	---------------------------------------	----------------------------------	------------------------------------	---------------------------------	------------------------------------