

<b>FREEWAY DIVERSION</b>	<b>DALLAS COUNTY IOWA</b>	<b>I-80 EASTBOUND</b>	<b>FROM:</b> Exit 110 (US 169)	<b>TO:</b> Exit 113 (R16)	<b>PLAN 2715 1/7</b>
------------------------------	-------------------------------	-----------------------	-----------------------------------	------------------------------	--------------------------

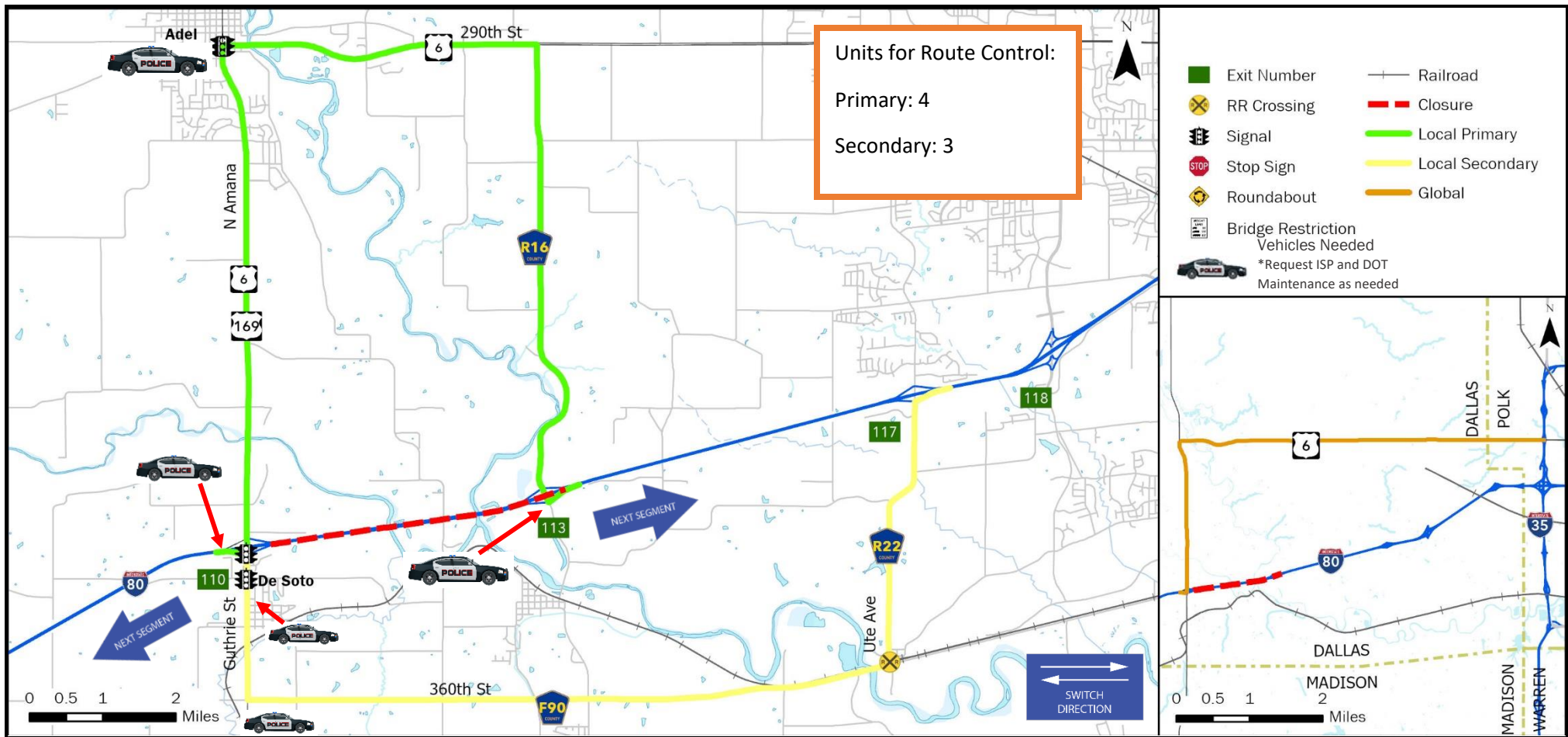

CRITICAL LOCATIONS TO MONITOR FOR LOCAL PRIMARY	AGENCIES TO NOTIFY	Iowa DOT TMC: 515-237-3300
I-80 EB Off Ramp to US 169 SB	Dallas County 911 Communications Center	515-993-4567
US 169 SB to F90 EB	Iowa DOT Statewide TMC	515-237-3300
F90 EB to R22	Iowa State Patrol Communications Center	800-525-5555
R22 NB at IAIS RR Crossing	Westcom Emergency Communications	515-222-3321
R22 NB to I-80 EB	Iowa Interstate Railroad (only if local secondary is used)	800-321-3891

<b>LOCAL DETOUR 1/7</b>	<b>GLOBAL DETOUR 2/7</b>	<b>CRITICAL LOCATIONS 3/7</b>	<b>RESPONSE PLAN 4/7</b>	<b>AGENCY CONTACTS 5/7</b>	<b>DMS MESSAGES 6/7</b>	<b>TRAFFIC CONTROL 7/7</b>
---------------------------------	----------------------------------	---------------------------------------	----------------------------------	------------------------------------	---------------------------------	------------------------------------

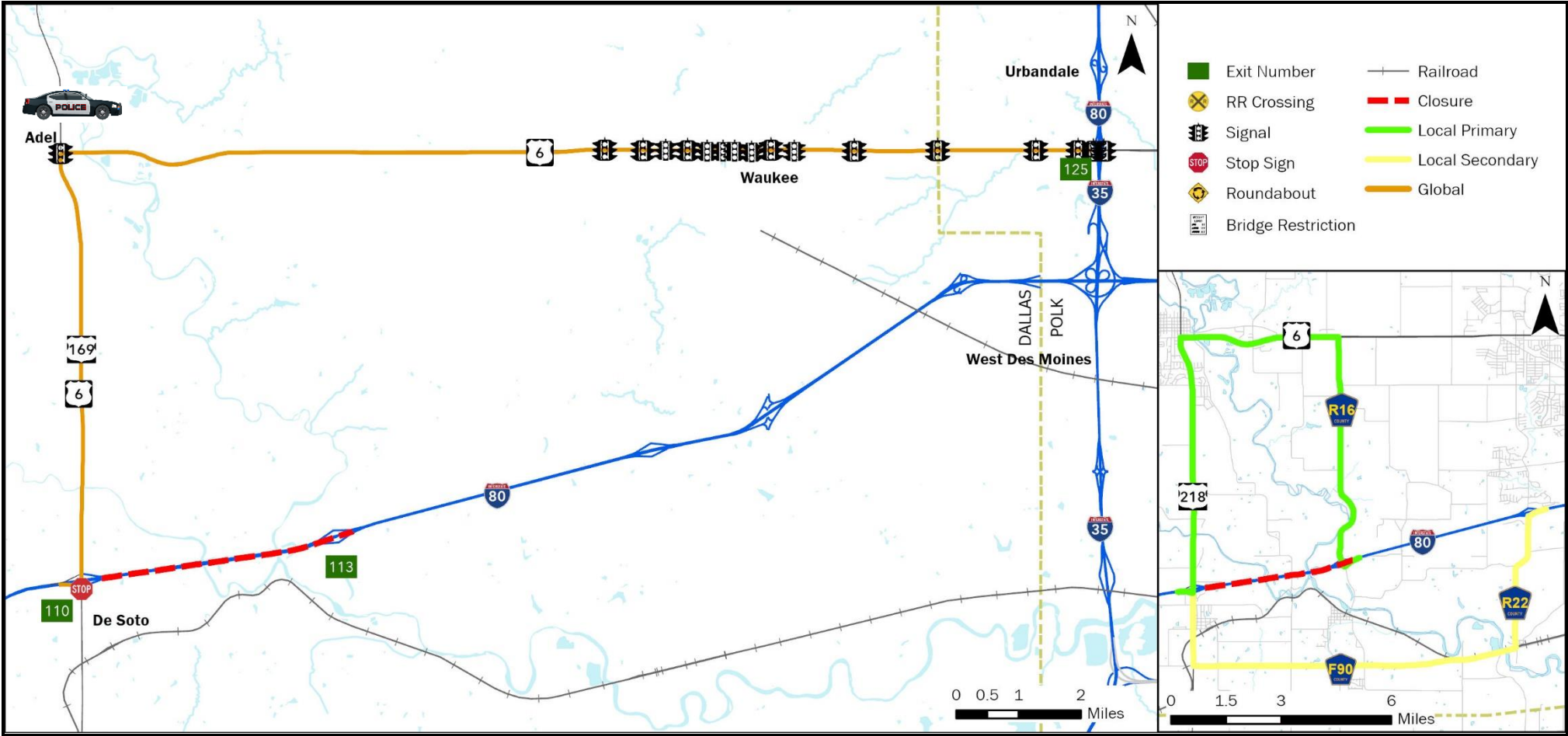

<b>CRITICAL LOCATIONS TO MONITOR FOR GLOBAL</b>	<b>AGENCIES TO NOTIFY</b>	Iowa DOT TMC: 515-237-3300
I-80 EB Off Ramp to US 169 NB US 169 NB to US 6 EB US 6 EB through Waukee US 6 EB to I-35	Dallas County 911 Communications Center Westcom Emergency Communications Iowa DOT Statewide TMC Iowa State Patrol Communications Center	515-993-4567 515-222-3321 515-237-3300 800-525-5555

<b>LOCAL DETOUR</b> <b>1/7</b>	<b>GLOBAL DETOUR</b> <b>2/7</b>	<b>CRITICAL LOCATIONS</b> <b>3/7</b>	<b>RESPONSE PLAN</b> <b>4/7</b>	<b>AGENCY CONTACTS</b> <b>5/7</b>	<b>DMS MESSAGES</b> <b>6/7</b>	<b>TRAFFIC CONTROL</b> <b>7/7</b>
-----------------------------------	------------------------------------	-----------------------------------------	------------------------------------	--------------------------------------	-----------------------------------	--------------------------------------

<b>FREEWAY DIVERSION</b>	<b>DALLAS COUNTY IOWA</b>	<b>I-80 EASTBOUND</b>	<b>FROM:</b> Exit 110 (US 169) <b>TO:</b> Exit 113 (R16)	<b>PLAN 2715 3/7</b>
<b>CRITICAL AREAS TO MONITOR</b>				

<b>LOCATION</b>	<b>EXIT</b>	<b>SITUATION</b>	<b>RESPONSE</b>
-----------------	-------------	------------------	-----------------

### Local Diversion - Primary

I-80 EB Off Ramp to US 169 SB	106	Traffic backing up onto interstate	Provide appropriate message on upstream DMS
US 169 SB to F90 EB		Traffic backing up and significant delays due to left turn	Notify local law enforcement
F90 EB to R22 NB	100	Traffic backing up and significant delays due to left turn	Notify local law enforcement
R22 NB at IAIS RR Crossing		Train blocking the crossing (Gates/Flashers)	Contact rail authority and notify local law enforcement
R22 NB to I-80 EB		Traffic returning to interstate	Monitor location

### Local Diversion - Secondary

I-80 EB Off Ramp to L Ave NB	106	Traffic backing up onto interstate	Provide appropriate message on upstream DMS
L Ave NB to Old Hwy 6 EB		Traffic backing up and delays due to signal and right turn	Traffic returning to interstate
Old Hwy 6 EB to US 169 SB		Traffic backing up and significant delays due to right turn	Notify local law enforcement
US 169 SB to I-80 EB	110	Traffic returning to interstate	Monitor location

### Global Diversion

I-80 EB Off Ramp to IA 25 SB	86	Traffic backing up onto interstate	Provide appropriate message on upstream DMS
IA 25 SB to IA 92 EB		Traffic backing up and delays due to signal and right turn	Notify local law enforcement
IA 92 EB to US 169 NB		Traffic backing up and delays due to signals (11 signals)	Confirm City of Waukee has been notified
US 169 NB to I-80 EB	110	Traffic returning to interstate	Monitor location

<b>LOCAL DETOUR 1/7</b>	<b>GLOBAL DETOUR 2/7</b>	<b>CRITICAL LOCATIONS 3/7</b>	<b>RESPONSE PLAN 4/7</b>	<b>AGENCY CONTACTS 5/7</b>	<b>DMS MESSAGES 6/7</b>	<b>TRAFFIC CONTROL 7/7</b>
---------------------------------	----------------------------------	---------------------------------------	----------------------------------	------------------------------------	---------------------------------	------------------------------------

<b>FREEWAY DIVERSION</b>	<b>DALLAS COUNTY IOWA</b>	<b>I-80 EASTBOUND</b>	<b>FROM:</b> Exit 110 (US 169) <b>TO:</b> Exit 113 (R16)	<b>PLAN 2715 4/7</b>
<b>ALTERNATE ROUTE RESPONSE PLAN</b>				

### Minor Impact to Traffic (Less Than 30 Minutes)

Off Peak Period – Shoulder Blocked	Diversion not implemented: <ul style="list-style-type: none"> <li>• On-scene traffic control</li> <li>• Deploy informational DMS messaging for approaching traffic</li> </ul>
Off Peak Period – Shoulder and One Lane Blocked	

### Intermediate Impact to Traffic (30 Minutes to 2 Hours)

Peak Period – Shoulder Blocked	Diversion not implemented: <ul style="list-style-type: none"> <li>• On-scene traffic control</li> <li>• Deploy informational DMS messaging for approaching traffic</li> </ul>
Off Period – Shoulder and One Lane Blocked	
Peak Period – Shoulder and One Lane Blocked	<b>Partial Diversion:</b> <ul style="list-style-type: none"> <li>• On-scene traffic control</li> <li>• Deploy informational DMS messaging for approaching traffic</li> <li>• Deploy DMS messaging directly through traffic to use diversion routes</li> <li>• Monitor local diversion routes at critical locations as needed</li> </ul>
All Lanes Blocked	<b>Full Diversion:</b> <ul style="list-style-type: none"> <li>• On-scene traffic control</li> <li>• Deploy DMS messaging directing all traffic to use diversion routes</li> <li>• Deploy law enforcement to direct traffic at critical locations</li> </ul>

### Major Impact to Traffic (Greater Than 2 Hours)

Peak Period – Shoulder Blocked	Diversion not implemented: <ul style="list-style-type: none"> <li>• On-scene traffic control</li> <li>• Deploy informational DMS messaging for approaching traffic</li> </ul>
Off Period – Shoulder and One Lane Blocked	
Peak Period – Shoulder and One Lane Blocked	<b>Partial/Discretionary Diversion:</b> <ul style="list-style-type: none"> <li>• Deploy cones, barricades, and other appropriate traffic control devices</li> <li>• Deploy informational DMS messaging for approaching traffic</li> <li>• Deploy DMS messaging directing through traffic to use diversion routes</li> <li>• Divert traffic to local diversion routes at discretion of incident commander</li> </ul>
All Lanes Blocked	<b>Full Diversion:</b> <ul style="list-style-type: none"> <li>• Deploy cones, barricades, and other appropriate traffic control devices</li> <li>• Deploy DMS messaging directing all traffic to use diversion routes</li> <li>• Deploy law enforcement to direct traffic at critical locations</li> </ul>

<b>LOCAL DETOUR 1/7</b>	<b>GLOBAL DETOUR 2/7</b>	<b>CRITICAL LOCATIONS 3/7</b>	<b>RESPONSE PLAN 4/7</b>	<b>AGENCY CONTACTS 5/7</b>	<b>DMS MESSAGES 6/7</b>	<b>TRAFFIC CONTROL 7/7</b>
---------------------------------	----------------------------------	---------------------------------------	----------------------------------	------------------------------------	---------------------------------	------------------------------------



<b>FREEWAY DIVERSION</b>	<b>DALLAS COUNTY IOWA</b>	<b>I-80 EASTBOUND</b>	<b>FROM:</b> Exit 110 (US 169) <b>TO:</b> Exit 113 (R16)	<b>PLAN 2715 5A/7</b>
<b>CRITICAL CONTACTS</b>				

Dallas County 911 Communications Center 515-993-4567	Iowa DOT Statewide TMC 515-237-3300	Iowa State Patrol Comm. Center 515-323-4360	Westcom Emergency Communications 515-222-3321
------------------------------------------------------------	----------------------------------------	---------------------------------------------------	-----------------------------------------------------

## RESPONSIBILITIES

<b>Dallas County 911 Communications Center</b>	<b>515-993-4567</b>
<p>Coordinate with the incident commander as to whether a diversion route is needed and which one should be implemented.</p> <ul style="list-style-type: none"> <li>• Notify Iowa DOT statewide TMC of route implemented, incident specific or maintenance needs, and who the incident commander is.</li> <li>• Dispatch County Sheriff, local law enforcement, and fire departments as needed.</li> <li>• Inform local municipalities including ADM Schools and other jurisdictions that a diversion route is being implemented.</li> <li>• Deploy law enforcement to direct traffic at critical locations as needed.</li> </ul> <p>Emergency Responders:</p> <ul style="list-style-type: none"> <li>• Secure scene.</li> <li>• Provide incident information, diversion route recommendations, and towing needs to E911.</li> <li>• Minimize impact to traffic.</li> <li>• Provide manual traffic control as needed, or as directed by E911 at critical locations.</li> </ul>	

<b>Iowa DOT Statewide TMC</b>	<b>515-237-3300</b>
<p>Determine and recommend diversion route to be implemented to county dispatch and state patrol. Deploy informational DMS and 511 messages to alert motorists of construction, delays, incidents, closures, etc. and/or directional DMS messaging to direct traffic to the implemented diversion route.</p> <ul style="list-style-type: none"> <li>• Monitor incidents and critical locations along the implemented diversion route.</li> <li>• Coordinate with Iowa DOT maintenance facilities regarding traffic control needs.</li> <li>• Deploy PDMS and Portable CCTV devices as needed for longer duration incidents.</li> <li>• Coordinate with local municipalities regarding the modification of signals, signal timing, or stop signs.</li> <li>• Coordinate with railroad authority regarding key crossings along the implemented diversion route.</li> </ul>	

<b>Iowa State Patrol Comm. Center</b>	<b>515-323-4360</b>
<p><u>Dispatch State Patrol.</u></p> <p><u>On-Scene Incident Commander:</u></p> <ul style="list-style-type: none"> <li>• Secure scene.</li> <li>• Notify appropriate communications center of incident location, anticipated duration, affected lanes, and identify the incident commander.</li> <li>• Coordinate with the communications center regarding diversion route needs.</li> <li>• Minimize impact to traffic through coordination of on-scene traffic control.</li> <li>• Ensure overweight and oversize vehicles are parked.</li> <li>• When the incident is safely cleared, notify the appropriate communications center that the diversion route is no longer needed.</li> </ul>	

<b>LOCAL DETOUR 1/7</b>	<b>GLOBAL DETOUR 2/7</b>	<b>CRITICAL LOCATIONS 3/7</b>	<b>RESPONSE PLAN 4/7</b>	<b>AGENCY CONTACTS 5/7</b>	<b>DMS MESSAGES 6/7</b>	<b>TRAFFIC CONTROL 7/7</b>
---------------------------------	----------------------------------	---------------------------------------	----------------------------------	------------------------------------	---------------------------------	------------------------------------

Iowa DOT TMC: 515-237-3300

ENSURE ALL OVERWEIGHT AND OVERSIZE VEHICLES ARE PARKED SAFELY

<b>FREEWAY DIVERSION</b>	<b>DALLAS COUNTY IOWA</b>	<b>I-80 EASTBOUND</b>	<b>FROM:</b> Exit 110 (US 169) <b>TO:</b> Exit 113 (R16)	<b>PLAN 2715 5A/7</b>
<b>CRITICAL CONTACTS</b>				

<b>Westcom Emergency Communications</b>	<b>515-222-3321</b>
Coordinate with the incident commander as to whether a diversion route is needed and which one should be implemented. <ul style="list-style-type: none"><li>• Notify Iowa DOT statewide TMC of route implemented, incident specific or maintenance needs, and who the incident commander is.</li><li>• Dispatch County Sheriff, local law enforcement, and fire departments as needed.</li><li>• Inform local municipalities including ADM Schools and other jurisdictions that a diversion route is being implemented.</li><li>• Deploy law enforcement to direct traffic at critical locations as needed.</li></ul> Emergency Responders: <ul style="list-style-type: none"><li>• Secure scene.</li><li>• Provide incident information, diversion route recommendations, and towing needs to E911.</li><li>• Minimize impact to traffic.</li><li>• Provide manual traffic control as needed, or as directed by E911 at critical locations.</li></ul>	

<b>LOCAL DETOUR 1/7</b>	<b>GLOBAL DETOUR 2/7</b>	<b>CRITICAL LOCATIONS 3/7</b>	<b>RESPONSE PLAN 4/7</b>	<b>AGENCY CONTACTS 5/7</b>	<b>DMS MESSAGES 6/7</b>	<b>TRAFFIC CONTROL 7/7</b>
---------------------------------	----------------------------------	---------------------------------------	----------------------------------	------------------------------------	---------------------------------	------------------------------------

<b>FREEWAY DIVERSION</b>	<b>DALLAS COUNTY IOWA</b>	<b>I-80 EASTBOUND</b>	<b>FROM:</b> Exit 110 (US 169) <b>TO:</b> Exit 113 (R16)	<b>PLAN 2715 5B/7</b>
<b>ADDITIONAL CONTACT INFORMATION</b>				

Iowa DOT Statewide TMC	
Iowa DOT Statewide TMC (Toll Free)	888-449-9672
Iowa DOT Maint. Garage – DeSoto	515-834-2368
Iowa Interstate Railroad Company (IAIS)	800-321-3891
Iowa DOT Motor Vehicle Enforcement	515-237-3300

Iowa State Patrol Comm. Center	
Iowa State Patrol – Central HQ	515-725-6090
Iowa State Patrol – District 1	515-725-0010
Iowa State Patrol – District 15	515-281-6176
Iowa State Patrol – District 16	515-281-3879

Dallas County 911 Communications Center	
Dallas County Sheriff	515-993-4567
Dallas County Emergency Mgmt.	515-993-9894
Dallas County Road Maintenance	515-993-5801

Madison County 911 Communications Center	
Madison County Sheriff	515-462-3575
Madison County Emergency Mgmt.	515-462-4255
Madison County Engineer’s Office	515-462-1136
Iowa Interstate (IAIS) Railroad Company	
IAIS Railroad Company	800-321-3891

City of Waukee	
Waukee Public Works POC	515-360-9973

<b>LOCAL DETOUR 1/7</b>	<b>GLOBAL DETOUR 2/7</b>	<b>CRITICAL LOCATIONS 3/7</b>	<b>RESPONSE PLAN 4/7</b>	<b>AGENCY CONTACTS 5/7</b>	<b>DMS MESSAGES 6/7</b>	<b>TRAFFIC CONTROL 7/7</b>
---------------------------------	----------------------------------	---------------------------------------	----------------------------------	------------------------------------	---------------------------------	------------------------------------

Iowa DOT TMC: 515-237-3300

ENSURE ALL OVERWEIGHT AND OVERSIZE VEHICLES ARE PARKED SAFELY

<b>FREEWAY DIVERSION</b>	<b>DALLAS COUNTY IOWA</b>	<b>I-80 EASTBOUND</b>	<b>FROM:</b> Exit 110 (US 169) <b>TO:</b> Exit 113 (R16)	<b>PLAN 2715 6/7</b>
<b>DMS MESSAGES</b> ✓				

<b>LOCAL PRIMARY</b>	<b>Sign Location</b>	<b>Page 1</b>	<b>Page 2</b>
	I-80 EB @ DeSoto - SM	I-80 E CLOSED AHEAD	DETOUR EXIT 110 US 6 E
	I-880 EB @ Beebeetown - SM	I-80E AT EXIT 110 CLOSED	DETOUR EXIT 110 US 6 E
	I-80 EB @ Old 83 - SM	I-80E AT EXIT 110 CLOSED	DETOUR EXIT 110 US 6 E
	Applicable On Route PDMS Messages	I-80E AT EXIT 110 CLOSED	DETOUR EXIT 110 US 6 E
	Applicable Off Route PDMS Messages	I-80E AT EXIT 110 CLOSED	USE ALT ROUTE

<b>LOCAL SECONDARY</b>	<b>Sign Location</b>	<b>Page 1</b>	<b>Page 2</b>
	I-80 EB @ DeSoto - SM	I-80 E CLOSED AHEAD	DETOUR EXIT 110 US 169 S
	I-880 EB @ Beebeetown - SM	I-80E AT EXIT 110 CLOSED	DETOUR EXIT 110 US 169 S
	I-80 EB @ Old 83 - SM	I-80E AT EXIT 110 CLOSED	DETOUR EXIT 110 US 169 S
	Applicable On Route PDMS Messages	I-80E AT EXIT 110 CLOSED	DETOUR EXIT 110 US 169 S
	Applicable Off Route PDMS Messages	I-80E AT EXIT 110 CLOSED	USE ALT ROUTE

<b>LOCAL DETOUR 1/7</b>	<b>GLOBAL DETOUR 2/7</b>	<b>CRITICAL LOCATIONS 3/7</b>	<b>RESPONSE PLAN 4/7</b>	<b>AGENCY CONTACTS 5/7</b>	<b>DMS MESSAGES 6/7</b>	<b>TRAFFIC CONTROL 7/7</b>
---------------------------------	----------------------------------	---------------------------------------	----------------------------------	------------------------------------	---------------------------------	------------------------------------



<b>FREEWAY DIVERSION</b>	<b>DALLAS COUNTY IOWA</b>	<b>I-80 EASTBOUND</b>	<b>FROM:</b> Exit 110 (US 169) <b>TO:</b> Exit 113 (R16)	<b>PLAN 2715 6/7</b>
<b>DMS MESSAGES</b> ✓				

<b>GLOBAL</b>	Sign Location	Page 1	Page 2
	I-80 EB @ DeSoto - SM	I-80 E CLOSED AHEAD	DETOUR EXIT 110 US 6 E
	I-880 EB @ Beebeetown - SM	I-80E AT EXIT 110 CLOSED	DETOUR EXIT 110 US 6 E
	I-80 EB @ Old 83 - SM	I-80E AT EXIT 110 CLOSED	DETOUR EXIT 110 US 6 E
	Applicable On Route PDMS Messages	I-80E AT EXIT 110 CLOSED	DETOUR EXIT 110 US 6 E
	Applicable Off Route PDMS Messages	I-80E AT EXIT 110 CLOSED	USE ALT ROUTE

<b>LOCAL DETOUR 1/7</b>	<b>GLOBAL DETOUR 2/7</b>	<b>CRITICAL LOCATIONS 3/7</b>	<b>RESPONSE PLAN 4/7</b>	<b>AGENCY CONTACTS 5/7</b>	<b>DMS MESSAGES 6/7</b>	<b>TRAFFIC CONTROL 7/7</b>
---------------------------------	----------------------------------	---------------------------------------	----------------------------------	------------------------------------	---------------------------------	------------------------------------

<b>FREEWAY DIVERSION</b>	<b>DALLAS COUNTY IOWA</b>	<b>I-80 EASTBOUND</b>	<b>FROM:</b> Exit 110 (US 169) <b>TO:</b> Exit 113 (R16)	<b>PLAN 2715 7/7</b>
<b>TRAFFIC CONTROL</b>				

<b>LOCATION</b>	<b>INITIAL ACTION/RESOURCE</b>	<b>EXTENDED ACTION/RESOURCE</b>
-----------------	--------------------------------	---------------------------------

### Local Diversion - Primary

I-80 EB Off Ramp to US 169 SB	Detour signing	Monitor location
US 169 SB to F90 EB	Detour signing	Manual traffic control (as needed/peak periods)
F90 EB to R22 NB	Detour signing	Manual traffic control (as needed/peak periods)
R22 NB at IAIS RR Crossing	Monitor location Coordinate with local law enforcement as necessary	Coordinate with IAIS Railroad and local law enforcement as necessary
R22 NB to I-80 EB	Monitor location	Monitor location

### Local Diversion - Secondary

I-80 EB Off Ramp to L Ave NB	Detour signing	Monitor location
US 169 NB to US 6 EB	Detour signing	Manual traffic control (as needed/peak periods)
US 6 EB to R16 SB	Detour signing	Manual traffic control (as needed/peak periods)
US 169 SB to I-80 EB	Monitor location	Monitor location

### Global Diversion

I-80 EB Off Ramp to IA 25 SB	Detour signing	Monitor location
IA 25 SB to IA 92 EB	Detour signing	Manual traffic control (as needed/peak periods)
IA 92 EB to US 169 NB	Monitor location Coordinate with local law enforcement as necessary	Coordinate with IAIS Railroad and local law enforcement as necessary
US 169 NB to I-80 EB	Monitor location	Monitor location

<b>LOCAL DETOUR 1/7</b>	<b>GLOBAL DETOUR 2/7</b>	<b>CRITICAL LOCATIONS 3/7</b>	<b>RESPONSE PLAN 4/7</b>	<b>AGENCY CONTACTS 5/7</b>	<b>DMS MESSAGES 6/7</b>	<b>TRAFFIC CONTROL 7/7</b>
---------------------------------	----------------------------------	---------------------------------------	----------------------------------	------------------------------------	---------------------------------	------------------------------------