

<b>FREEWAY DIVERSION</b>	<b>LINN COUNTY IOWA</b>	<b>I-380 SOUTHBOUND</b>	<b>FROM:</b> Exit 22 (32nd St)	<b>TO:</b> Exit 21 (H Ave)	<b>PLAN 3320 1/7</b>
------------------------------	-----------------------------	-----------------------------	-----------------------------------	-------------------------------	--------------------------

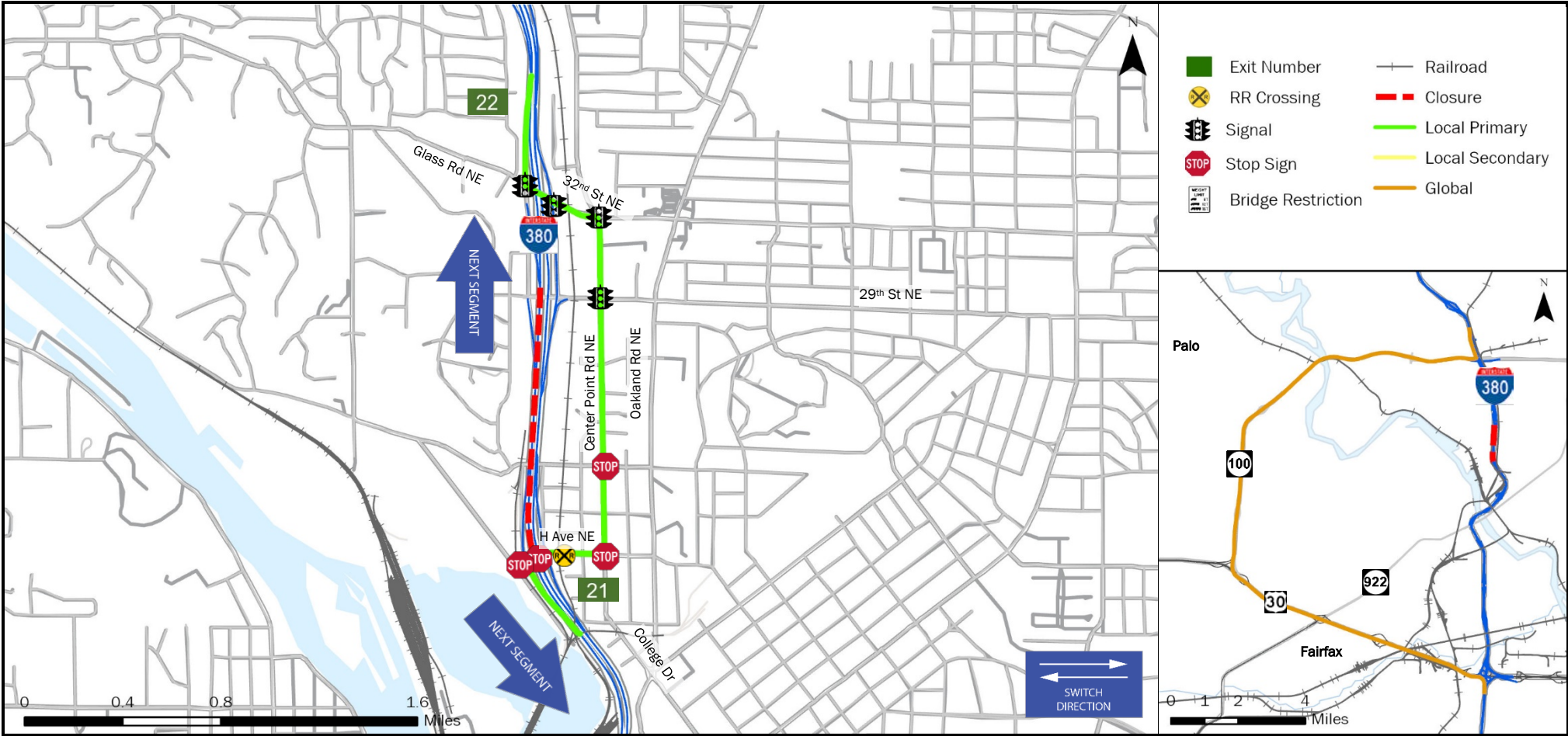

<b>CRITICAL LOCATIONS TO MONITOR FOR LOCAL PRIMARY</b>	<b>AGENCIES TO NOTIFY</b>	Iowa DOT TMC: 515-237-3300
I-380 SB Off Ramp to 32nd St NE EB 32nd St NE EB to Center Point Rd NE SB Center Point Rd NE SB to H Ave NE WB H Ave NE WB to I-380 SB On Ramp	Linn County Emergency Communications Center Iowa Department of Public Safety Communications Center Iowa DOT Traffic Management Center	319-892-6500 319-396-4414 515-237-3300

<b>LOCAL DETOUR 1/7</b>	<b>GLOBAL DETOUR 2/7</b>	<b>CRITICAL LOCATIONS 3/7</b>	<b>RESPONSE PLAN 4/7</b>	<b>AGENCY CONTACTS 5/7</b>	<b>DMS MESSAGES 6/7</b>	<b>TRAFFIC CONTROL 7/7</b>
---------------------------------	----------------------------------	---------------------------------------	----------------------------------	------------------------------------	---------------------------------	------------------------------------

<b>FREEWAY DIVERSION</b>	<b>LINN COUNTY IOWA</b>	<b>I-380 SOUTHBOUND</b>	<b>FROM:</b> Exit 22 (32nd St)	<b>TO:</b> Exit 21 (H Ave)	<b>PLAN 3320 2/7</b>
------------------------------	-----------------------------	-----------------------------	-----------------------------------	-------------------------------	--------------------------

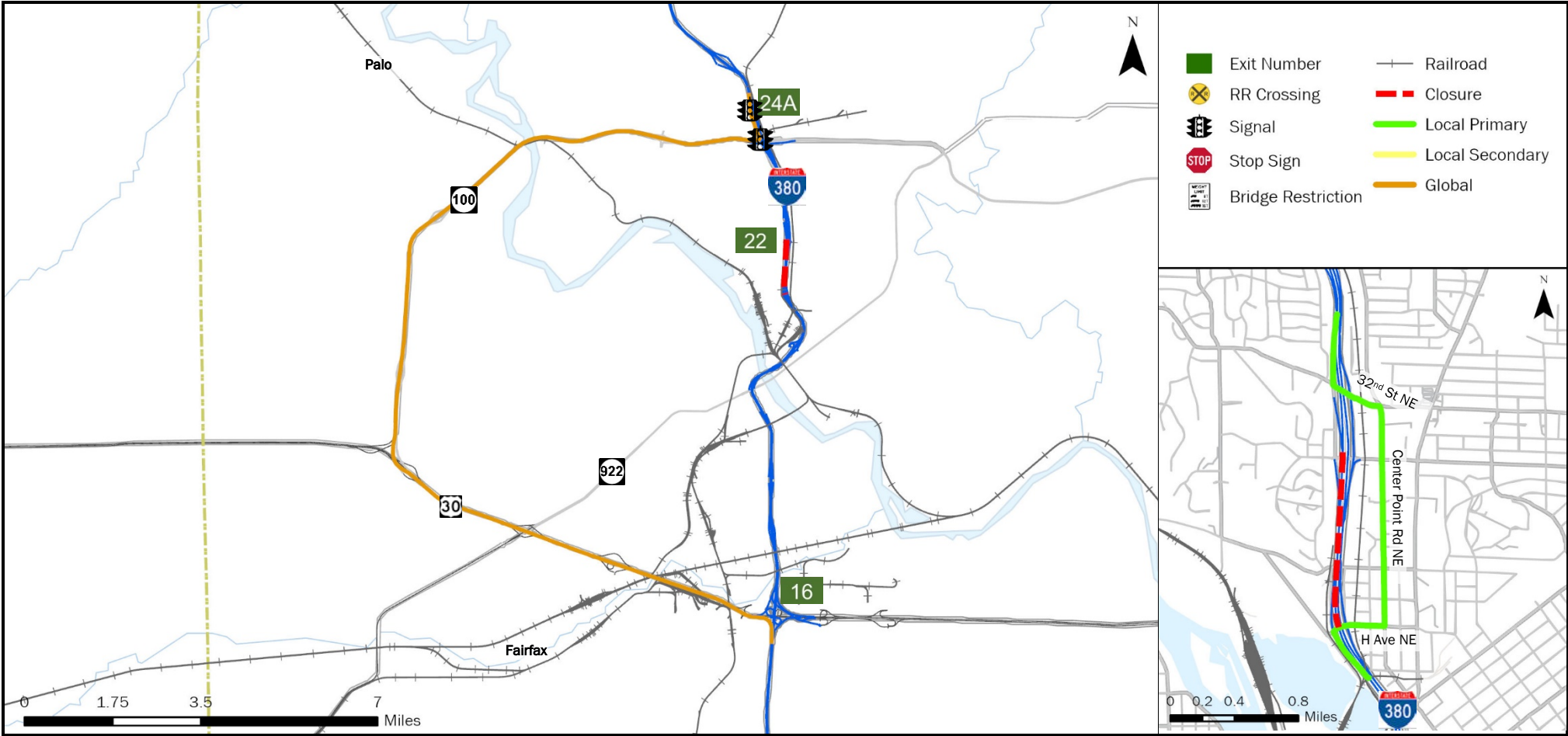

<b>CRITICAL LOCATIONS TO MONITOR FOR GLOBAL</b>	<b>AGENCIES TO NOTIFY</b>	Iowa DOT TMC: 515-237-3300
I-380 SB Off Ramp at Blairs Ferry Dr I-380 SB Frontage to IA 100 WB IA 100 WB to US 30 EB US 30 EB to I-380 SB On Ramp	Linn County Emergency Communications Center Iowa Department of Public Safety Communications Center Iowa DOT Traffic Management Center	319-892-6500 319-396-4414 515-237-3300

<b>LOCAL DETOUR 1/7</b>	<b>GLOBAL DETOUR 2/7</b>	<b>CRITICAL LOCATIONS 3/7</b>	<b>RESPONSE PLAN 4/7</b>	<b>AGENCY CONTACTS 5/7</b>	<b>DMS MESSAGES 6/7</b>	<b>TRAFFIC CONTROL 7/7</b>
---------------------------------	----------------------------------	---------------------------------------	----------------------------------	------------------------------------	---------------------------------	------------------------------------

Iowa DOT TMC: 515-237-3300

ENSURE ALL OVERWEIGHT AND OVERSIZE VEHICLES ARE PARKED SAFELY

<b>FREEWAY DIVERSION</b>	<b>LINN COUNTY IOWA</b>	<b>I-380 SOUTHBOUND</b>	<b>FROM:</b> Exit 22 (32nd St) <b>TO:</b> Exit 21 (H Ave)	<b>PLAN 3320 3/7</b>
<b>CRITICAL AREAS TO MONITOR</b>				

LOCATION	EXIT	SITUATION	RESPONSE
----------	------	-----------	----------

**Local Diversion - Primary**

I-380 SB Off Ramp to 32nd St NE EB	22	Traffic backing up onto interstate	Provide appropriate message on upstream DMS
32nd St NE EB to Center Point Rd NE SB		Traffic backing up and significant delays due to 2 traffic signals	Notify local law enforcement
Center Point Rd NE SB to H Ave NE WB		Traffic backing up and significant delays due to a traffic signal and/or 2 stop sign	Notify local law enforcement
H Ave NE WB to I-380 SB On Ramp	21	Traffic backing up and significant delays due to 2 stop signs and/or train blocking the crossing	Contact UP Railroad and notify local law enforcement

**Local Diversion - Primary**

<b>NO LOCAL SECONDARY AVAILABLE</b>
-------------------------------------

**Global Diversion**

I-380 SB Off Ramp at Blairs Ferry Dr	24	Traffic backing up and significant delays due to a traffic signal	Notify local law enforcement
I-380 SB Frontage to IA 100 WB		Traffic merging onto highway	Monitor location
IA 100 WB to US 30 EB		Traffic merging onto highway	Monitor location
US 30 EB to I-380 SB On Ramp	252B	Traffic merging onto interstate	Monitor location

<b>LOCAL DETOUR 1/7</b>	<b>GLOBAL DETOUR 2/7</b>	<b>CRITICAL LOCATIONS 3/7</b>	<b>RESPONSE PLAN 4/7</b>	<b>AGENCY CONTACTS 5/7</b>	<b>DMS MESSAGES 6/7</b>	<b>TRAFFIC CONTROL 7/7</b>
---------------------------------	----------------------------------	---------------------------------------	----------------------------------	------------------------------------	---------------------------------	------------------------------------

<b>FREEWAY DIVERSION</b>	<b>LINN COUNTY IOWA</b>	<b>I-380 SOUTHBOUND</b>	<b>FROM:</b> Exit 22 (32nd St) <b>TO:</b> Exit 21 (H Ave)	<b>PLAN 3320 4/7</b>
<b>ALTERNATE ROUTE RESPONSE PLAN</b>				

### Minor Impact to Traffic (Less Than 30 Minutes)

Off Peak – Shoulder Blocked	Diversion not implemented: <ul style="list-style-type: none"> <li>• On-scene traffic control</li> <li>• Deploy informational DMS messaging for approaching traffic</li> </ul>
Off Peak – Shoulder and One Lane Blocked	

### Intermediate Impact to Traffic (30 Minutes to 2 Hours)

Peak Period – Shoulder Blocked	Diversion not implemented: <ul style="list-style-type: none"> <li>• On-scene traffic control</li> <li>• Deploy informational DMS messaging for approaching traffic</li> </ul>
Off Period – Shoulder and One Lane Blocked	
Peak Period – Shoulder and One Lane Blocked	<b>Partial Diversion:</b> <ul style="list-style-type: none"> <li>• On-scene traffic control</li> <li>• Deploy informational DMS messaging for approaching traffic</li> <li>• Deploy DMS messaging directing through traffic to use diversion route</li> <li>• Monitor local diversion routes at critical locations as needed</li> </ul>
All Lanes Blocked	<b>Full Diversion:</b> <ul style="list-style-type: none"> <li>• On-scene traffic control</li> <li>• Deploy DMS messaging directing all traffic to use diversion routes</li> <li>• Deploy law enforcement to direct traffic at critical locations</li> </ul>

### Major Impact to Traffic (Greater Than 2 Hours)

Peak Period – Shoulder Blocked	Diversion not implemented: <ul style="list-style-type: none"> <li>• On-scene traffic control</li> <li>• Deploy informational DMS messaging for approaching traffic</li> </ul>
Off Period – Shoulder and One Lane Blocked	
Peak Period – Shoulder and One Lane Blocked	<b>Partial/Discretionary Diversion:</b> <ul style="list-style-type: none"> <li>• Deploy cones, barricades, and other appropriate traffic control devices</li> <li>• Deploy informational DMS messaging for approaching traffic</li> <li>• Deploy DMS messaging directing through traffic to use diversion route</li> <li>• Divert traffic to local diversion routes at discretion of incident commander</li> </ul>
All Lanes Blocked	<b>Full Diversion:</b> <ul style="list-style-type: none"> <li>• Deploy cones, barricades, and other appropriate traffic control devices</li> <li>• Deploy DMS messaging directing all traffic to use diversion routes</li> <li>• Deploy law enforcement to direct traffic at critical locations</li> </ul>

<b>LOCAL DETOUR 1/7</b>	<b>GLOBAL DETOUR 2/7</b>	<b>CRITICAL LOCATIONS 3/7</b>	<b>RESPONSE PLAN 4/7</b>	<b>AGENCY CONTACTS 5/7</b>	<b>DMS MESSAGES 6/7</b>	<b>TRAFFIC CONTROL 7/7</b>
---------------------------------	----------------------------------	---------------------------------------	----------------------------------	------------------------------------	---------------------------------	------------------------------------

<b>FREEWAY DIVERSION</b>	<b>LINN COUNTY IOWA</b>	<b>I-380 SOUTHBOUND</b>	<b>FROM:</b> Exit 22 (32nd St) <b>TO:</b> Exit 21 (H Ave)	<b>PLAN 3320 5A/7</b>
------------------------------	-----------------------------	-----------------------------	--	---------------------------

<b>CRITICAL CONTACTS</b>
--------------------------

Linn County Emergency Communications Center 319-892-6500	Iowa DOT Traffic Management Center 515-237-3300	Iowa Department of Public Safety Communications Center 319-396-4414
--	---	---

## RESPONSIBILITIES

<b>Linn County Emergency Communications Division</b>	<b>319-892-6275</b>
Coordinate with the incident commander as to whether a diversion route is needed and which one should be implemented. <ul style="list-style-type: none"> <li>• Notify Iowa DOT statewide TMC of route implemented, incident specific or maintenance needs, and who the incident commander is.</li> <li>• Dispatch County Sheriff, local law enforcement, and fire departments as needed.</li> <li>• Inform local municipalities and other jurisdictions that a diversion route is being implemented.</li> <li>• Deploy law enforcement to direct traffic at critical locations as needed.</li> </ul>	
<u>Emergency Responders:</u> <ul style="list-style-type: none"> <li>• Secure scene.</li> <li>• Provide incident information, diversion route recommendations, and towing needs to E911.</li> <li>• Minimize impact to traffic.</li> <li>• Ensure overweight and oversize vehicles are parked.</li> <li>• </li> <li>• Provide manual traffic control as needed, or as directed by E911 at critical locations.</li> </ul>	

<b>Iowa DOT Traffic Management Center</b>	<b>515-237-3300</b>
Deploy informational DMS and 511 messages to alert motorists of construction, delays, incidents, closures, etc. and/or directional DMS messaging to direct traffic to the implemented diversion route. <ul style="list-style-type: none"> <li>• Monitor incidents and critical locations along the implemented diversion route.</li> <li>• Coordinate with Iowa DOT maintenance facilities regarding traffic control needs.</li> <li>• Deploy PDMS and Portable CCTV devices as needed for longer duration incidents.</li> <li>• Coordinate with local municipalities regarding the modification of signals, signal timing, or stop signs.</li> <li>• Coordinate with railroad authority regarding key crossings along the implemented diversion route.</li> </ul>	

<b>Iowa Department of Public Safety Communications Center</b>	<b>319-396-4414</b>
Dispatch State Patrol.	
<u>On-Scene Incident Commander:</u> <ul style="list-style-type: none"> <li>• Secure scene.</li> <li>• Notify appropriate communications center of incident location, anticipated duration, affected lanes, and identify the incident commander.</li> <li>• Coordinate with the communications center regarding diversion route needs.</li> <li>• Minimize impact to traffic through coordination of on-scene traffic control.</li> <li>• Ensure overweight and oversize vehicles are parked.</li> <li>• When the incident is safely cleared, notify the appropriate communications center that the diversion route is no longer needed.</li> </ul>	

<b>LOCAL DETOUR 1/7</b>	<b>GLOBAL DETOUR 2/7</b>	<b>CRITICAL LOCATIONS 3/7</b>	<b>RESPONSE PLAN 4/7</b>	<b>AGENCY CONTACTS 5/7</b>	<b>DMS MESSAGES 6/7</b>	<b>TRAFFIC CONTROL 7/7</b>
---------------------------------	----------------------------------	---------------------------------------	----------------------------------	------------------------------------	---------------------------------	------------------------------------

Iowa DOT TMC: 515-237-3300

**ENSURE ALL OVERWEIGHT AND OVERSIZE VEHICLES ARE PARKED SAFELY**



<b>FREEWAY DIVERSION</b>	<b>LINN COUNTY IOWA</b>	<b>I-380 SOUTHBOUND</b>	<b>FROM:</b> Exit 22 (32nd St) <b>TO:</b> Exit 21 (H Ave)	<b>PLAN 3320 5B/7</b>
<b>ADDITIONAL CONTACT INFORMATION</b>				

<b>Linn County Emergency Communications Division</b>	
Linn County Sheriff	319-892-6100
Linn County Emergency Management	319-892-6500
Linn County Engineering Department	319-892-6404
Cedar Rapids Police Department	319-286-5529
Cedar Rapids Fire Department	319-286-5200
Hiawatha Police Department	319-393-1212
Hiawatha Fire Department	319-393-4180

<b>Iowa Department of Public Safety Communications Center</b>	
Iowa State Patrol – District 9	319-266-2677

<b>Iowa DOT Traffic Management Center</b>	
Iowa DOT Statewide TMC (Toll Free)	888-449-9672
Iowa DOT Maint. Supervisor – Cedar Rapids	319-350-1764
Iowa DOT Main Garage - Cedar Rapids	319-364-8189
Iowa DOT Maint. Supervisor –Marion	319-480-0588
Iowa DOT Main Garage – Marion	319-373-1277
Union Pacific Railway Co.	402-544-5000
Chicago, Central and Pacific Railroad Co.	514-399-8740
Cedar Rapids and Iowa City Railway Co. (CIC)	800-283-1540
Iowa DOT Motor Vehicle Division	515-237-3268
Area 4 Motor Vehicle Enforcement	319-560-8502

<b>LOCAL DETOUR 1/7</b>	<b>GLOBAL DETOUR 2/7</b>	<b>CRITICAL LOCATIONS 3/7</b>	<b>RESPONSE PLAN 4/7</b>	<b>AGENCY CONTACTS 5/7</b>	<b>DMS MESSAGES 6/7</b>	<b>TRAFFIC CONTROL 7/7</b>
Iowa DOT TMC: 515-237-3300			ENSURE ALL OVERWEIGHT AND OVERSIZE VEHICLES ARE PARKED SAFELY			

<b>FREEWAY DIVERSION</b>	<b>LINN COUNTY IOWA</b>	<b>I-380 SOUTHBOUND</b>	<b>FROM:</b> Exit 22 (32nd St) <b>TO:</b> Exit 21 (H Ave)	<b>PLAN 3320 6/7</b>
<b>DMS MESSAGES</b>				

<b>LOCAL PRIMARY</b>	<b>Sign Location</b>	<b>Page 1</b>	<b>Page 2</b>
	<b>NO DMS AVAILABLE</b>		

<b>LOCAL SECONDARY</b>	<b>Sign Location</b>	<b>Page 1</b>	<b>Page 2</b>
	<b>NO LOCAL SECONDARY AVAILABLE</b>		

<b>GLOBAL</b>	<b>Sign Location</b>	<b>Page 1</b>	<b>Page 2</b>
	<b>NO DMS AVAILABLE</b>		

<b>LOCAL DETOUR 1/7</b>	<b>GLOBAL DETOUR 2/7</b>	<b>CRITICAL LOCATIONS 3/7</b>	<b>RESPONSE PLAN 4/7</b>	<b>AGENCY CONTACTS 5/7</b>	<b>DMS MESSAGES 6/7</b>	<b>TRAFFIC CONTROL 7/7</b>
---------------------------------	----------------------------------	---------------------------------------	----------------------------------	------------------------------------	---------------------------------	------------------------------------

<b>FREEWAY DIVERSION</b>	<b>LINN COUNTY IOWA</b>	<b>I-380 SOUTHBOUND</b>	<b>FROM:</b> Exit 22 (32nd St) <b>TO:</b> Exit 21 (H Ave)	<b>PLAN 3320 7/7</b>
<b>TRAFFIC CONTROL</b>				

LOCATION	INITIAL ACTION/RESOURCE	EXTENDED ACTION/RESOURCE
----------	-------------------------	--------------------------

**Local Diversion - Primary**

I-380 SB Off Ramp to 32 <sup>nd</sup> St NE EB	Detour signing	Monitor location
32 <sup>nd</sup> St NE EB to Center Point Rd NE SB	Detour signing	Manual traffic control (as needed/peak periods)
Center Point Rd NE SB to H Ave NE WB	Detour signing	Manual traffic control (as needed/peak periods)
H Ave NE WB to I-380 SB On Ramp	Monitor location Coordinate with local law enforcement as necessary	Coordinate with UP Railway and manual traffic control (as needed/peak periods)

**Global Diversion**

I-380 SB Off Ramp at Blairs Ferry Dr	Detour signing	Manual traffic control (as needed/peak periods)
I-380 SB Frontage to IA 100 WB	Monitor location	Monitor location
IA 100 WB to US 30 EB	Monitor location	Monitor location
US 30 EB to I-380 SB On Ramp	Monitor location	Monitor location

<b>LOCAL DETOUR 1/7</b>	<b>GLOBAL DETOUR 2/7</b>	<b>CRITICAL LOCATIONS 3/7</b>	<b>RESPONSE PLAN 4/7</b>	<b>AGENCY CONTACTS 5/7</b>	<b>DMS MESSAGES 6/7</b>	<b>TRAFFIC CONTROL 7/7</b>
---------------------------------	----------------------------------	---------------------------------------	----------------------------------	------------------------------------	---------------------------------	------------------------------------