

<b>FREEWAY DIVERSION</b>	<b>POLK COUNTY IOWA</b>	<b>I-35 SOUTHBOUND</b>	<b>FROM:</b> Exit 90 (SE Oralabor Road)	<b>TO:</b> Exit 89 (Corporate Woods Dr.)	<b>PLAN 6210 1/7</b>
------------------------------	-----------------------------	----------------------------	--	--	--------------------------

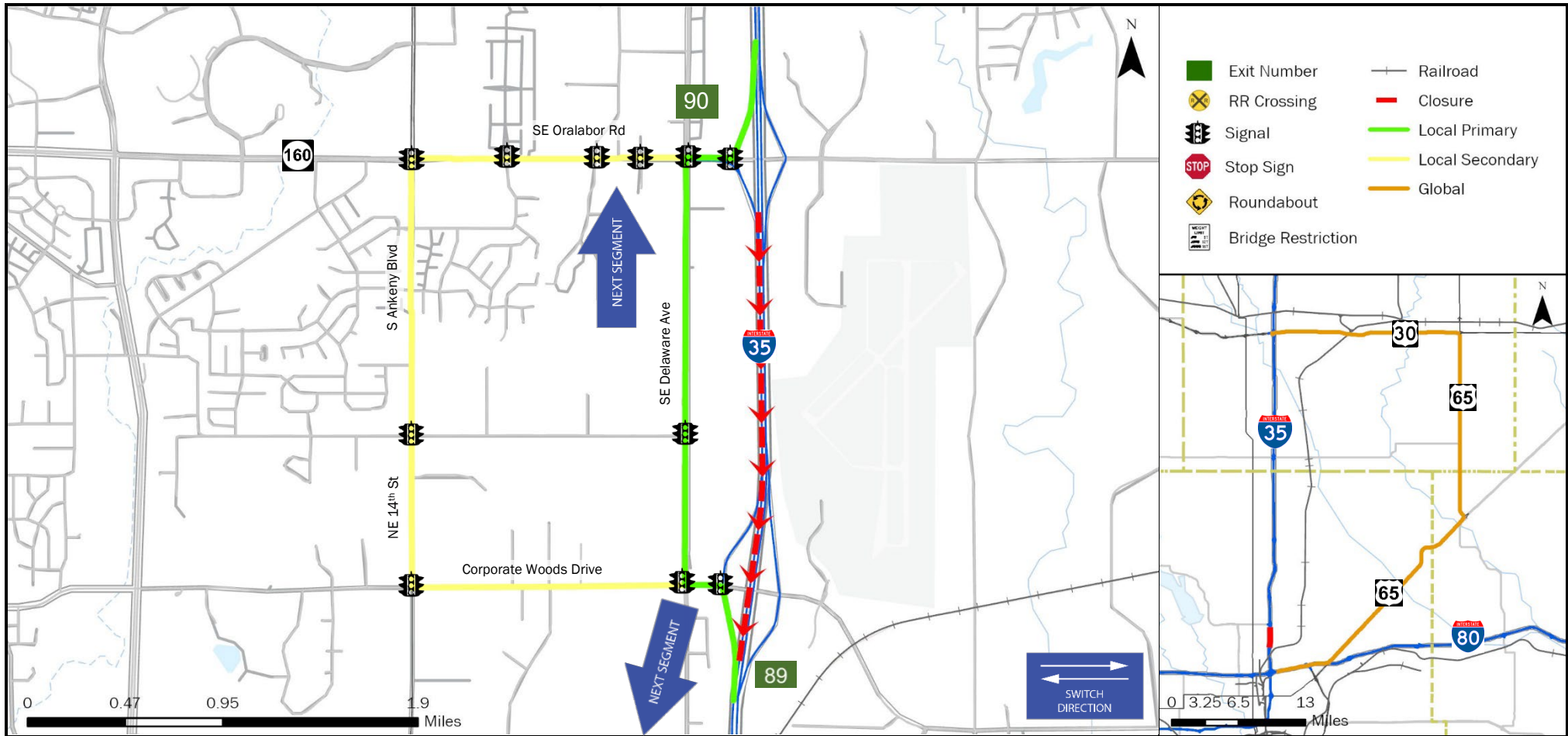

<b>CRITICAL LOCATIONS TO MONITOR FOR LOCAL PRIMARY</b>	<b>AGENCIES TO NOTIFY</b>	Iowa DOT TMC: 515-237-3300
SB I-35 Off Ramp to SE Oralabor Rd. (1 Signal) SE Oralabor Rd. to SE Delaware Ave. (1 Signal) SE Oralabor Rd. WB to SE Delaware Ave. SB SE Delaware Ave. to Corporate Woods Drive (2 Signals) SE Delaware Ave. SB to Corporate Woods Drive EB Corporate Woods Drive EB to I-35 SB (1 Signal) Corporate Woods Drive EB to I-35 SB	Polk County Communications Iowa DOT Statewide TMC Iowa State Patrol Comm. Center Ankeny Traffic Engineer	515-286-3333 515-237-3300 515-323-4360 515-494-7237

<b>LOCAL DETOUR 1/7</b>	<b>GLOBAL DETOUR 2/7</b>	<b>CRITICAL LOCATIONS 3/7</b>	<b>RESPONSE PLAN 4/7</b>	<b>AGENCY CONTACTS 5/7</b>	<b>DMS MESSAGES 6/7</b>	<b>TRAFFIC CONTROL 7/7</b>
---------------------------------	----------------------------------	---------------------------------------	----------------------------------	------------------------------------	---------------------------------	------------------------------------

Iowa DOT TMC: 515-237-3300

ENSURE ALL OVERWEIGHT AND OVERSIZE VEHICLES ARE PARKED SAFELY

Last update: 6/28/2022

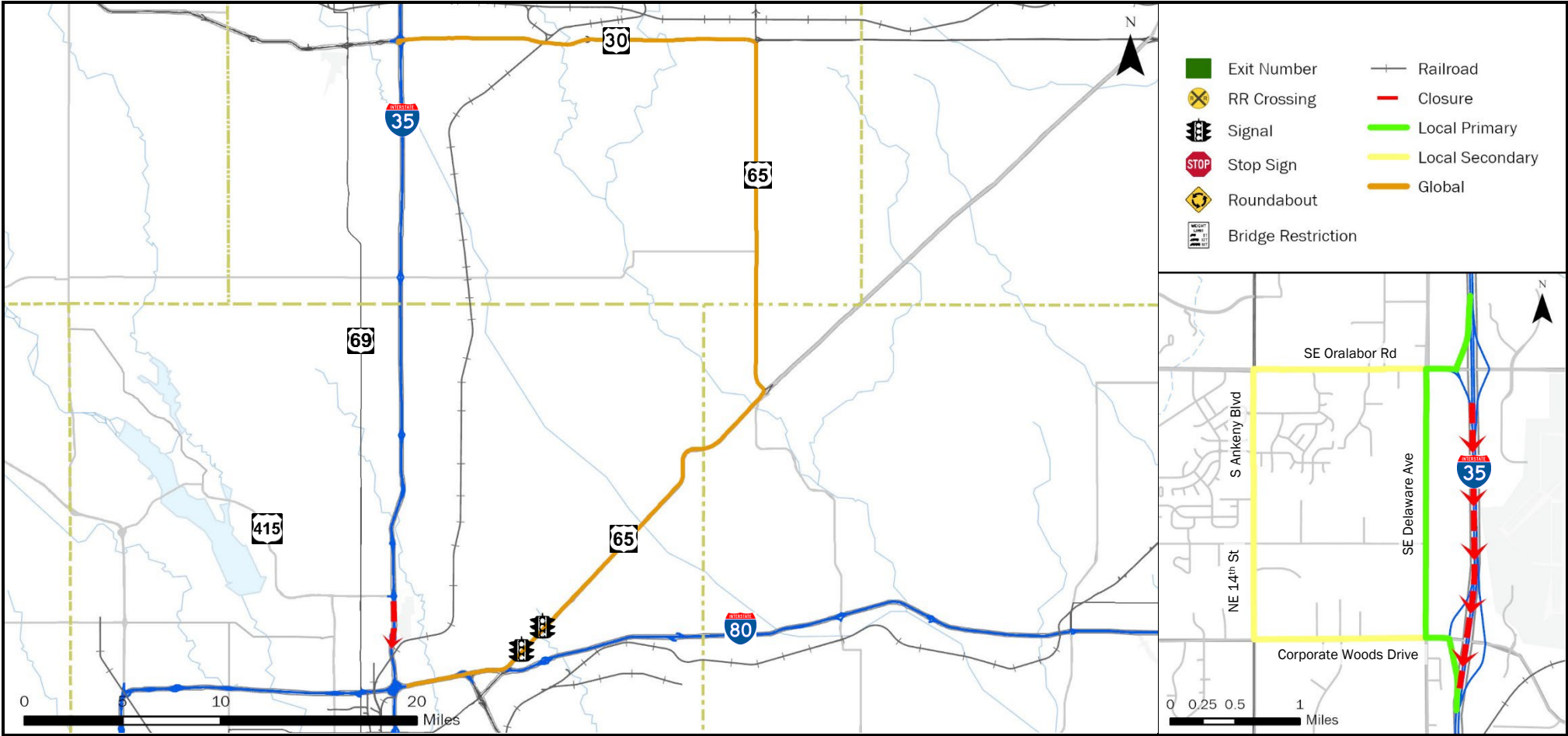

CRITICAL LOCATIONS TO MONITOR FOR GLOBAL	AGENCIES TO NOTIFY	Iowa DOT TMC: 515-237-3300
I-35 SB Off Ramp to US 30 EB US 30 EB to US 65 SB US 65 SB to US 65 SB On Ramp at US 65/IA 330 Interchange US 65 Between US 65/IA 330 Interchange and I-80 (1 Signal) US 65 SB to I-80 WB I-80 WB to I-35 SB	Polk County Communications Iowa DOT Statewide TMC Iowa State Patrol Comm. Center Ankeny Traffic Engineer Union Pacific Railroad Company (UP)	515-286-3333 515-237-3300 515-323-4360 515-494-7237 888-877-7267

<b>FREEWAY DIVERSION</b>	<b>POLK COUNTY IOWA</b>	<b>I-35 SOUTHBOUND</b>	<b>FROM:</b> Exit 90 (SE Oralabor Road) <b>TO:</b> Exit 89 (Corporate Woods Dr.)	<b>PLAN 6210 3/7</b>
<b>CRITICAL AREAS TO MONITOR</b>				

<b>LOCATION</b>	<b>EXIT</b>	<b>SITUATION</b>	<b>RESPONSE</b>
-----------------	-------------	------------------	-----------------

### Local Diversion - Primary

NB I-35 Off Ramp to Oralabor Rd. (1 Signal)	90	Traffic backing up on ramp due to signalized intersection	Provide appropriate message on upstream DMS. Confirm City of Ankeny has been notified.
SE Oralabor Rd. to SE Delaware Ave. (1 Signal)		Traffic backing up due to signalized intersection	Confirm City of Ankeny has been notified.
SE Oralabor Rd. WB to SE Delaware Ave. SB		Traffic backing up and significant delays due to turning left	Notify local law enforcement
SE Delaware Ave. to Corporate Woods Drive (2 Signals)		Traffic backing up due to 2 signalized intersections	Confirm City of Ankeny has been notified.
SE Delaware Ave. SB to Corporate Woods Drive EB		Traffic backing up and significant delays due to turning left	Notify local law enforcement
Corporate Woods Drive EB to I-35 SB (1 Signal)		Traffic backing up due to signalized intersection	Confirm City of Ankeny has been notified.
Corporate Woods Drive EB to I-35 SB	89	Traffic backing up at ramp due to signalized intersection	Monitor location. Confirm City of Ankeny has been notified.

### Local Diversion - Secondary

NB I-35 Off Ramp to SE Oralabor Rd WB (1 Signal)	90	Traffic backing up on ramp due to signalized intersection	Provide appropriate message on upstream DMS Confirm City of Ankeny has been notified.
SE Oralabor Rd Between I-35 & US 69/NE 14th St (5 Signals)		Traffic backing up due to signalized intersection	Confirm City of Ankeny has been notified.
SE Oralabor Rd WB to US 69/NE 14th St SB		Traffic backing up and significant delays due to turning left	Notify local law enforcement
US 69/NE 14 St Between SE Oralabor Rd & NE 66th Ave (2 Signals)		Traffic backing up due to signalized intersection	Confirm Polk County and City of Ankeny have been notified.
US 69/NE 14th St SB to NE 66th Ave EB		Traffic backing up and significant delays due to turning left	Notify local law enforcement
NE 66th Ave EB Between US 69/NE 14th St and I-35 SB (2 Signals)	89	Traffic backing up due to signalized intersection	Confirm City of Ankeny has been notified.

<b>LOCAL DETOUR 1/7</b>	<b>GLOBAL DETOUR 2/7</b>	<b>CRITICAL LOCATIONS 3/7</b>	<b>RESPONSE PLAN 4/7</b>	<b>AGENCY CONTACTS 5/7</b>	<b>DMS MESSAGES 6/7</b>	<b>TRAFFIC CONTROL 7/7</b>
---------------------------------	----------------------------------	---------------------------------------	----------------------------------	------------------------------------	---------------------------------	------------------------------------

<b>FREEWAY DIVERSION</b>	<b>POLK COUNTY IOWA</b>	<b>I-35 SOUTHBOUND</b>	<b>FROM:</b> Exit 90 (SE Oralabor Road) <b>TO:</b> Exit 89 (Corporate Woods Dr.)	<b>PLAN 6210 3/7</b>
<b>CRITICAL AREAS TO MONITOR</b>				

Global Diversion

I-35 SB Off Ramp to US 30 EB	111A	Traffic backing up due to merge at loop ramp	Provide appropriate message on upstream DMS
US 30 EB to US 65 SB		Traffic backing up and significant delays due to right turn	Notify local law enforcement
US 65 SB to US 65 SB On Ramp at US 65/IA 330 Interchange		Traffic backing up and significant delays due to right turn	Monitor location
US 65 Between US 65/IA 330 Interchange and I-80 (1 Signal)		Traffic backing up due to signalized intersection	Monitor location. Confirm City of Altoona has been notified.
US 65 SB to I-80 WB		Traffic backing up and significant delays due to right turn	Monitor location
I-80 WB to I-35 SB	137A	East Mixmaster Interchange	Monitor location

<b>LOCAL DETOUR 1/7</b>	<b>GLOBAL DETOUR 2/7</b>	<b>CRITICAL LOCATIONS 3/7</b>	<b>RESPONSE PLAN 4/7</b>	<b>AGENCY CONTACTS 5/7</b>	<b>DMS MESSAGES 6/7</b>	<b>TRAFFIC CONTROL 7/7</b>
---------------------------------	----------------------------------	---------------------------------------	----------------------------------	------------------------------------	---------------------------------	------------------------------------

<b>FREEWAY DIVERSION</b>	<b>POLK COUNTY IOWA</b>	<b>I-35 SOUTHBOUND</b>	<b>FROM:</b> Exit 90 (SE Oralabor Road) <b>TO:</b> Exit 89 (Corporate Woods Dr.)	<b>PLAN 6210 4/7</b>
<b>ALTERNATE ROUTE RESPONSE PLAN</b>				

### Minor Impact to Traffic (Less Than 30 Minutes)

Off Peak Period – Shoulder Blocked	Diversion not implemented: <ul style="list-style-type: none"> <li>• On-scene traffic control</li> <li>• Deploy informational DMS messaging for approaching traffic</li> </ul>
Off Peak Period – Shoulder and One Lane Blocked	

### Intermediate Impact to Traffic (30 Minutes to 2 Hours)

Peak Period – Shoulder Blocked	Diversion not implemented: <ul style="list-style-type: none"> <li>• On-scene traffic control</li> <li>• Deploy informational DMS messaging for approaching traffic</li> </ul>
Off Period – Shoulder and One Lane Blocked	
Peak Period – Shoulder and One Lane Blocked	<b>Partial Diversion:</b> <ul style="list-style-type: none"> <li>• On-scene traffic control</li> <li>• Deploy informational DMS messaging for approaching traffic</li> <li>• Deploy DMS messaging directly through traffic to use diversion routes</li> <li>• Monitor local diversion routes at critical locations as needed</li> </ul>
All Lanes Blocked	<b>Full Diversion:</b> <ul style="list-style-type: none"> <li>• On-scene traffic control</li> <li>• Deploy DMS messaging directing all traffic to use diversion routes</li> <li>• Deploy law enforcement to direct traffic at critical locations</li> </ul>

### Major Impact to Traffic (Greater Than 2 Hours)

Peak Period – Shoulder Blocked	Diversion not implemented: <ul style="list-style-type: none"> <li>• On-scene traffic control</li> <li>• Deploy informational DMS messaging for approaching traffic</li> </ul>
Off Period – Shoulder and One Lane Blocked	
Peak Period – Shoulder and One Lane Blocked	<b>Partial/Discretionary Diversion:</b> <ul style="list-style-type: none"> <li>• Deploy cones, barricades, and other appropriate traffic control devices</li> <li>• Deploy informational DMS messaging for approaching traffic</li> <li>• Deploy DMS messaging directing through traffic to use diversion routes</li> <li>• Divert traffic to local diversion routes at discretion of incident commander</li> </ul>
All Lanes Blocked	<b>Full Diversion:</b> <ul style="list-style-type: none"> <li>• Deploy cones, barricades, and other appropriate traffic control devices</li> <li>• Deploy DMS messaging directing all traffic to use diversion routes</li> <li>• Deploy law enforcement to direct traffic at critical locations</li> </ul>

<b>LOCAL DETOUR 1/7</b>	<b>GLOBAL DETOUR 2/7</b>	<b>CRITICAL LOCATIONS 3/7</b>	<b>RESPONSE PLAN 4/7</b>	<b>AGENCY CONTACTS 5/7</b>	<b>DMS MESSAGES 6/7</b>	<b>TRAFFIC CONTROL 7/7</b>
---------------------------------	----------------------------------	---------------------------------------	----------------------------------	------------------------------------	---------------------------------	------------------------------------



<b>FREEWAY DIVERSION</b>	<b>POLK COUNTY IOWA</b>	<b>I-35 SOUTHBOUND</b>	<b>FROM:</b> Exit 90 (SE Oralabor Road) <b>TO:</b> Exit 89 (Corporate Woods Dr.)	<b>PLAN 6210 5A/7</b>
<b>CRITICAL CONTACTS</b>				

<b>Polk County Communications</b> 515-286-3333	<b>Iowa DOT Statewide TMC</b> 515-237-3300	<b>Iowa State Patrol Comm. Center</b> 515-323-4360	<b>Ankeny Traffic Engineer</b> 515-494-7237	<b>Union Pacific Railroad Company</b> 888-877-7267
---	---	---	--	---

## RESPONSIBILITIES

<b>Polk County Communications</b>	<b>515-286-3333</b>
<p>Coordinate with the incident commander as to whether a diversion route is needed and which one should be implemented.</p> <ul style="list-style-type: none"> <li>Notify Iowa DOT statewide TMC of route implemented, incident specific or maintenance needs, and who the incident commander is.</li> <li>Dispatch County Sheriff, local law enforcement, and fire departments as needed.</li> <li>Inform local municipalities and other jurisdictions that a diversion route is being implemented.</li> <li>Deploy law enforcement to direct traffic at critical locations as needed.</li> </ul> <p><u>Emergency Responders:</u></p> <ul style="list-style-type: none"> <li>Secure scene.</li> <li>Provide incident information, diversion route recommendations, and towing needs to E911.</li> <li>Minimize impact to traffic.</li> <li>Provide manual traffic control as needed, or as directed by E911 at critical locations</li> </ul>	

<b>Iowa DOT Statewide TMC</b>	<b>515-237-3300</b>
<p>Deploy informational DMS and 511 messages to alert motorists of construction, delays, incidents, closures, etc. and/or directional DMS messaging to direct traffic to the implemented diversion route.</p> <ul style="list-style-type: none"> <li>Monitor incidents and critical locations along the implemented diversion route.</li> <li>Coordinate with Iowa DOT maintenance facilities regarding traffic control needs.</li> <li>Deploy PDMS and Portable CCTV devices as needed for longer duration incidents.</li> <li>Coordinate with local municipalities regarding the modification of signals, signal timing, or stop signs.</li> <li>Coordinate with railroad authority regarding key crossings along the implemented diversion route.</li> </ul>	

<b>Iowa State Patrol Comm. Center</b>	<b>515-323-4360</b>
Dispatch State Patrol.	
<p><u>On-Scene Incident Commander:</u></p> <ul style="list-style-type: none"> <li>Secure scene.</li> <li>Notify appropriate communications center of incident location, anticipated duration, affected lanes, and identify the incident commander.</li> <li>Coordinate with the communications center regarding diversion route needs.</li> <li>Minimize impact to traffic through coordination of on-scene traffic control.</li> <li>Ensure overweight and oversize vehicles are parked.</li> <li>When the incident is safely cleared, notify the appropriate communications center that the diversion route is no longer needed.</li> </ul>	

<b>LOCAL DETOUR</b> 1/7	<b>GLOBAL DETOUR</b> 2/7	<b>CRITICAL LOCATIONS</b> 3/7	<b>RESPONSE PLAN</b> 4/7	<b>AGENCY CONTACTS</b> 5/7	<b>DMS MESSAGES</b> 6/7	<b>TRAFFIC CONTROL</b> 7/7
--------------------------------	---------------------------------	--------------------------------------	---------------------------------	-----------------------------------	--------------------------------	-----------------------------------

Iowa DOT TMC: 515-237-3300

ENSURE ALL OVERWEIGHT AND OVERSIZE VEHICLES ARE PARKED SAFELY

<b>FREEWAY DIVERSION</b>	<b>POLK COUNTY IOWA</b>	<b>I-35 SOUTHBOUND</b>	<b>FROM:</b> Exit 90 (SE Oralabor Road) <b>TO:</b> Exit 89 (Corporate Woods Dr.)	<b>PLAN 6210 5B/7</b>
<b>ADDITIONAL CONTACT INFORMATION</b>				

<b>Polk County Communications</b>	
Des Moines Dispatch	515-283-4811

<b>Iowa DOT Statewide TMC</b>	
Iowa DOT Statewide TMC (Toll Free)	888-449-9672
Iowa DOT Maint. Garage – Des Moines	515-265-1614
Union Pacific RR. Co.	888-877-7267

<b>Iowa State Patrol Comm. Center</b>	
Iowa State Patrol – District 1	515-725-0010
Iowa State Patrol – District 15	515-281-6176
Iowa State Patrol – District 16	515-281-3879
Iowa State Patrol – Central HQ	515-725-6090

<b>Ankeny Traffic Engineer</b>	
Ankeny Traffic Engineer	515-494-7237

<b>LOCAL DETOUR 1/7</b>	<b>GLOBAL DETOUR 2/7</b>	<b>CRITICAL LOCATIONS 3/7</b>	<b>RESPONSE PLAN 4/7</b>	<b>AGENCY CONTACTS 5/7</b>	<b>DMS MESSAGES 6/7</b>	<b>TRAFFIC CONTROL 7/7</b>
Iowa DOT TMC: 515-237-3300			ENSURE ALL OVERWEIGHT AND OVERSIZE VEHICLES ARE PARKED SAFELY			

<b>FREEWAY DIVERSION</b>	<b>POLK COUNTY IOWA</b>	<b>I-35 SOUTHBOUND</b>	<b>FROM:</b> Exit 90 (SE Oralabor Road) <b>TO:</b> Exit 89 (Corporate Woods Dr.)	<b>PLAN 6210 6/7</b>
<b>DMS MESSAGES</b>				

<b>LOCAL PRIMARY</b>	<b>Sign Location</b>	<b>Page 1</b>	<b>Page 2</b>
	I-35 SB @ Elkhart - (SM)	I-35S AT EXIT 90 CLOSED	DETOUR EXIT 90
	I-35 SB @ IA 210 - (OH)	ROAD CLOSED AT EXIT 90 DETOUR ORALABOR E	ROAD CLOSED AT EXIT 90 PREPARE TO STOP

<b>LOCAL SECONDARY</b>	<b>Sign Location</b>	<b>Page 1</b>	<b>Page 2</b>
	<b>NO DMS AVAILABLE</b>		

<b>GLOBAL</b>	<b>Sign Location</b>	<b>Page 1</b>	<b>Page 2</b>
	<b>NO DMS AVAILABLE</b>		

<b>LOCAL DETOUR 1/7</b>	<b>GLOBAL DETOUR 2/7</b>	<b>CRITICAL LOCATIONS 3/7</b>	<b>RESPONSE PLAN 4/7</b>	<b>AGENCY CONTACTS 5/7</b>	<b>DMS MESSAGES 6/7</b>	<b>TRAFFIC CONTROL 7/7</b>
---------------------------------	----------------------------------	---------------------------------------	----------------------------------	------------------------------------	---------------------------------	------------------------------------



<b>FREEWAY DIVERSION</b>	<b>POLK COUNTY IOWA</b>	<b>I-35 SOUTHBOUND</b>	<b>FROM:</b> Exit 90 (SE Oralabor Road) <b>TO:</b> Exit 89 (Corporate Woods Dr.)	<b>PLAN 6210 7/7</b>
<b>TRAFFIC CONTROL</b>				

<b>LOCATION</b>	<b>INITIAL ACTION/RESOURCE</b>	<b>EXTENDED ACTION/RESOURCE</b>
-----------------	--------------------------------	---------------------------------

### Local Diversion - Primary

NB I-35 Off Ramp to Oralabor Rd./ NE 78th Ave. (1 Signal)	Detour Signing	Adjust Signal Timing Manual Traffic Control (as needed/peak periods)
SE Oralabor Rd. to SE Delaware Ave. (1 Signal)	Detour Signing	Adjust Signal Timing Manual Traffic Control (as needed/peak periods)
SE Oralabor Rd. WB to SE Delaware Ave. SB	Detour Signing	Manual traffic control (as needed/peak periods)
SE Delaware Ave. to Corporate Woods Drive (2 Signals)	Detour Signing	Adjust Signal Timing Manual Traffic Control (as needed/peak periods)
SE Delaware Ave. SB to Corporate Woods Drive EB	Detour Signing	Manual traffic control (as needed/peak periods)
Corporate Woods Drive EB to I-35 SB (1 Signal)	Detour Signing	Adjust Signal Timing Manual Traffic Control (as needed/peak periods)
Corporate Woods Drive EB to I-35 SB	Detour Signing	Adjust Signal Timing Manual Traffic Control (as needed/peak periods)

### Local Diversion - Secondary

NB I-35 Off Ramp to SE Oralabor Rd WB (1 Signal)	Detour Signing	Adjust Signal Timing Manual Traffic Control (as needed/peak periods)
SE Oralabor Rd Between I-35 & US 69/NE 14th St (5 Signals)	Detour Signing	Adjust Signal Timing Manual Traffic Control (as needed/peak periods)
SE Oralabor Rd WB to US 69/NE 14th St SB.	Detour Signing	Manual traffic control (as needed/peak periods)
US 69/NE 14 St Between SE Oralabor Rd & NE 66th Ave (2 Signals)	Detour Signing	Adjust Signal Timing Manual Traffic Control (as needed/peak periods)
US 69/NE 14th St SB to NE 66th Ave EB	Detour Signing	Manual traffic control (as needed/peak periods)
NE 66th Ave EB Between US 69/NE 14th St and I-35 SB (2 Signals)	Detour Signing	Adjust Signal Timing Manual Traffic Control (as needed/peak periods)

<b>LOCAL DETOUR 1/7</b>	<b>GLOBAL DETOUR 2/7</b>	<b>CRITICAL LOCATIONS 3/7</b>	<b>RESPONSE PLAN 4/7</b>	<b>AGENCY CONTACTS 5/7</b>	<b>DMS MESSAGES 6/7</b>	<b>TRAFFIC CONTROL 7/7</b>
---------------------------------	----------------------------------	---------------------------------------	----------------------------------	------------------------------------	---------------------------------	------------------------------------

<b>FREEWAY DIVERSION</b>	<b>POLK COUNTY IOWA</b>	<b>I-35 SOUTHBOUND</b>	<b>FROM:</b> Exit 90 (SE Oralabor Road) <b>TO:</b> Exit 89 (Corporate Woods Dr.)	<b>PLAN 6210 7/7</b>
<b>TRAFFIC CONTROL</b>				

**Global Diversion**

I-35 SB Off Ramp to US 30 EB	Detour Signing	Monitor location
US 30 EB to US 65 SB	Detour Signing	Monitor location
US 65 SB to US 65 SB On Ramp at US 65/IA 330 Interchange	Detour Signing	Monitor location
US 65 Between US 65/IA 330 Interchange and I-80 (1 Signal)	Detour Signing	Adjust Signal Timing Manual Traffic Control (as needed/peak periods)
US 65 SB to I-80 WB	Detour Signing	Monitor location
I-80 WB to I-35 SB	Detour Signing	Monitor location

<b>LOCAL DETOUR 1/7</b>	<b>GLOBAL DETOUR 2/7</b>	<b>CRITICAL LOCATIONS 3/7</b>	<b>RESPONSE PLAN 4/7</b>	<b>AGENCY CONTACTS 5/7</b>	<b>DMS MESSAGES 6/7</b>	<b>TRAFFIC CONTROL 7/7</b>
---------------------------------	----------------------------------	---------------------------------------	----------------------------------	------------------------------------	---------------------------------	------------------------------------