

FREEWAY DIVERSION	POLK COUNTY IOWA	I-35 SOUTHBOUND	FROM: Exit 96 (NE 126th Avenue)	TO: Exit 94 (NE 36th Street)	PLAN 6216 1/7
--------------------------	-------------------------	------------------------	-------------------------------------------	----------------------------------------	--------------------------------

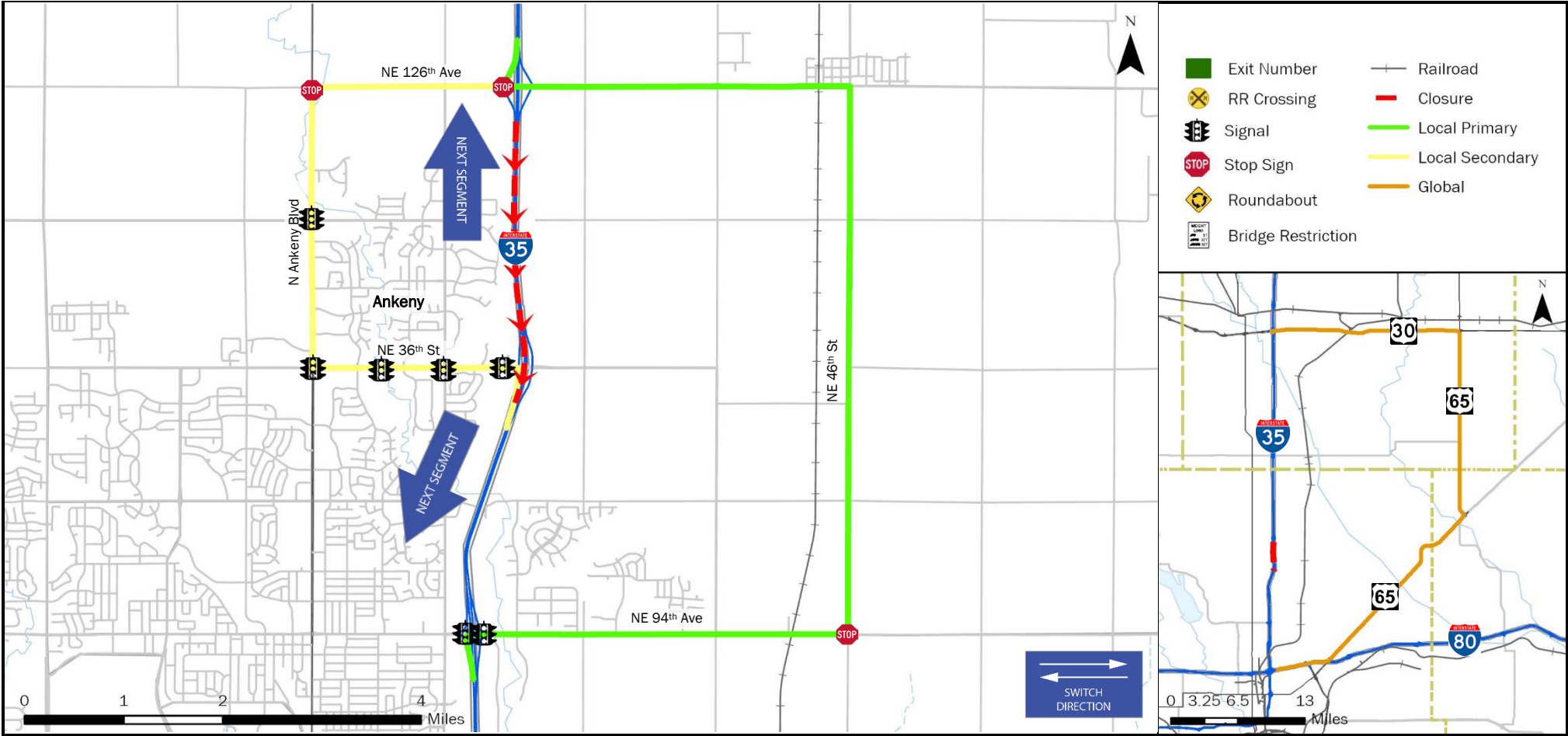

CRITICAL LOCATIONS TO MONITOR FOR LOCAL PRIMARY	AGENCIES TO NOTIFY	Iowa DOT TMC: 515-237-3300
SB I-35 Off Ramp to NE 126 th Ave EB NE 126 th Ave at Union Pacific Railroad Crossing NE 126 th Ave EB to NE 46 th St SB NE 46 th St SB to NE 94 th Ave WB NE 94 th Ave at Union Pacific Railroad Crossing NE 94 th Ave WB to I-35 SB (2 Signals)	Polk County Communications Iowa DOT Statewide TMC Iowa State Patrol Comm. Center Ankeny Traffic Engineer Union Pacific Railroad Company (UP)	515-286-3333 515-237-3300 800-525-5555 515-494-7237 888-877-7267

LOCAL DETOUR 1/7	GLOBAL DETOUR 2/7	CRITICAL LOCATIONS 3/7	RESPONSE PLAN 4/7	AGENCY CONTACTS 5/7	DMS MESSAGES 6/7	TRAFFIC CONTROL 7/7
---------------------------------	----------------------------------	---------------------------------------	----------------------------------	------------------------------------	---------------------------------	------------------------------------

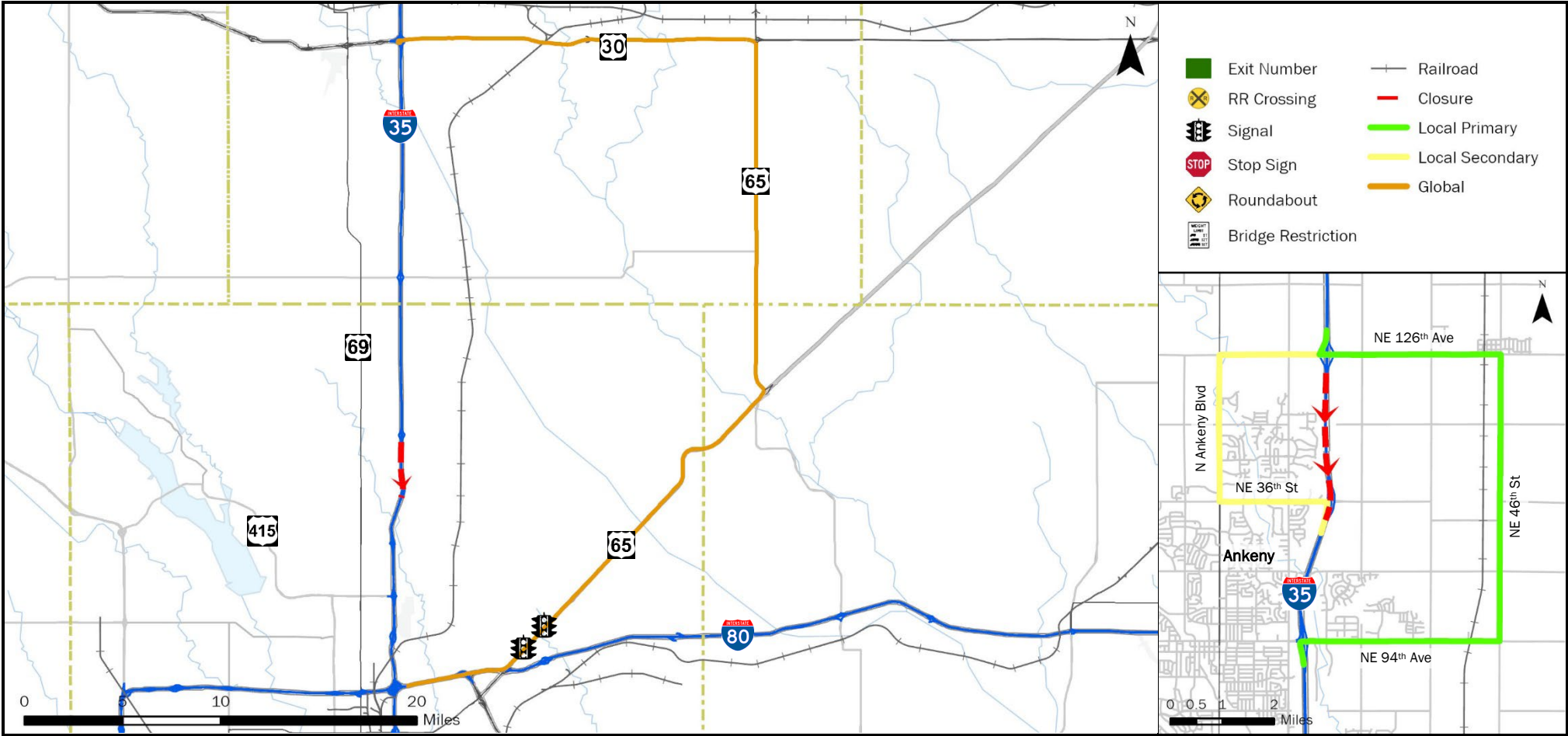

CRITICAL LOCATIONS TO MONITOR FOR GLOBAL		AGENCIES TO NOTIFY	
Iowa DOT TMC: 515-237-3300		Iowa DOT TMC: 515-237-3300	
I-35 SB Off Ramp to US 30 EB		Polk County Communications	515-286-3333
US 30 EB to US 65 SB		Iowa DOT Statewide TMC	515-237-3300
US 65 SB to US 65 SB On Ramp at US 65/IA 330 Interchange		Iowa State Patrol Comm. Center	800-525-5555
US 65 Between US 65/IA 330 Interchange and I-80 (1 Signal)		Ankeny Traffic Engineer	515-494-7237
US 65 SB to I-80 WB		Union Pacific Railroad Company (UP)	888-877-7267
I-80 WB to I-35 SB			

FREEWAY DIVERSION	POLK COUNTY IOWA	I-35 SOUTHBOUND	FROM: Exit 96 (NE 126th Avenue) TO: Exit 94 (NE 36 th Street)	PLAN 6216 3/7
CRITICAL AREAS TO MONITOR				

LOCATION	EXIT	SITUATION	RESPONSE
-----------------	-------------	------------------	-----------------

Local Diversion - Primary

SB I-35 Off Ramp to NE 126th Ave EB	96	Traffic backing up on ramp	Provide appropriate message on upstream DMS.
NE 126th Ave at Union Pacific Railroad Crossing		Train blocking the crossing (Gates/Flashers)	Contact Union Pacific Railroad and Notify local law enforcement.
NE 126th Ave EB to NE 46th St SB		Traffic backing up at intersection and significant delays due to right turn	Notify local law enforcement
NE 46th St SB to NE 94th Ave WB		Traffic backing up at intersection and significant delays due to right turn	Notify local law enforcement
NE 94th Ave at Union Pacific Railroad Crossing		Train blocking the crossing (Gates/Flashers)	Contact Union Pacific Railroad and Notify local law enforcement.
NE 94th Ave WB to I-35 SB (2 Signals)	92	Traffic backing up due to 2 signalized intersections	Monitor location and notify local law enforcement.

Local Diversion - Secondary

SB I-35 Off Ramp to NE 126th Ave WB	96	Traffic backing up on ramp	Provide appropriate message on upstream DMS.
NE 126th Ave WB to US 69/North Ankeny Blvd SB		Traffic backing up and significant delays due to left turn	Notify local law enforcement
US 69/North Ankeny Blvd Between NE 126th Ave & NE 36th St (2 Signals)		Traffic backing up due to 2 signalized intersections	Notify local law enforcement. Confirm City of Ankeny has been notified.
US69/North Ankeny Ave SB to NE 36th St EB		Traffic backing up and significant delays due to left turn	Notify local law enforcement
NE 36th St EB Between US 69/North Ankeny Blvd & I-35 (1 Signal)		Traffic backing up due to signalized intersection	Notify local law enforcement. Confirm City of Ankeny has been notified.
NE 36th St EB to I-35 SB	94	Traffic backing up and significant delays due to right turn	Monitor location

LOCAL DETOUR 1/7	GLOBAL DETOUR 2/7	CRITICAL LOCATIONS 3/7	RESPONSE PLAN 4/7	AGENCY CONTACTS 5/7	DMS MESSAGES 6/7	TRAFFIC CONTROL 7/7
---------------------------------	----------------------------------	---------------------------------------	----------------------------------	------------------------------------	---------------------------------	------------------------------------

FREEWAY DIVERSION	POLK COUNTY IOWA	I-35 SOUTHBOUND	FROM: Exit 96 (NE 126th Avenue) TO: Exit 94 (NE 36 th Street)	PLAN 6216 3/7
CRITICAL AREAS TO MONITOR				

Global Diversion

I-35 SB Off Ramp to US 30 EB	111A	Traffic backing up due to merge at loop ramp	Provide appropriate message on upstream DMS
US 30 EB to US 65 SB		Traffic backing up and significant delays due to right turn	Notify local law enforcement
US 65 SB to US 65 SB On Ramp at US 65/IA 330 Interchange		Traffic backing up and significant delays due to right turn	Monitor location
US 65 Between US 65/IA 330 Interchange and I-80 (1 Signal)		Traffic backing up due to signalized intersection	Monitor location. Confirm City of Altoona has been notified.
US 65 SB to I-80 WB		Traffic backing up and significant delays due to right turn	Monitor location
I-80 WB to I-35 SB	137A	East Mixmaster Interchange	Monitor location

FREEWAY DIVERSION	POLK COUNTY IOWA	I-35 SOUTHBOUND	FROM: Exit 96 (NE 126th Avenue) TO: Exit 94 (NE 36 th Street)	PLAN 6216 4/7
ALTERNATE ROUTE RESPONSE PLAN				

Minor Impact to Traffic (Less Than 30 Minutes)

Off Peak Period – Shoulder Blocked	Diversion not implemented: <ul style="list-style-type: none"> • On-scene traffic control • Deploy informational DMS messaging for approaching traffic
Off Peak Period – Shoulder and One Lane Blocked	

Intermediate Impact to Traffic (30 Minutes to 2 Hours)

Peak Period – Shoulder Blocked	Diversion not implemented: <ul style="list-style-type: none"> • On-scene traffic control • Deploy informational DMS messaging for approaching traffic
Off Period – Shoulder and One Lane Blocked	
Peak Period – Shoulder and One Lane Blocked	Partial Diversion: <ul style="list-style-type: none"> • On-scene traffic control • Deploy informational DMS messaging for approaching traffic • Deploy DMS messaging directly through traffic to use diversion routes • Monitor local diversion routes at critical locations as needed
All Lanes Blocked	Full Diversion: <ul style="list-style-type: none"> • On-scene traffic control • Deploy DMS messaging directing all traffic to use diversion routes • Deploy law enforcement to direct traffic at critical locations

Major Impact to Traffic (Greater Than 2 Hours)

Peak Period – Shoulder Blocked	Diversion not implemented: <ul style="list-style-type: none"> • On-scene traffic control • Deploy informational DMS messaging for approaching traffic
Off Period – Shoulder and One Lane Blocked	
Peak Period – Shoulder and One Lane Blocked	Partial/Discretionary Diversion: <ul style="list-style-type: none"> • Deploy cones, barricades, and other appropriate traffic control devices • Deploy informational DMS messaging for approaching traffic • Deploy DMS messaging directing through traffic to use diversion routes • Divert traffic to local diversion routes at discretion of incident commander
All Lanes Blocked	Full Diversion: <ul style="list-style-type: none"> • Deploy cones, barricades, and other appropriate traffic control devices • Deploy DMS messaging directing all traffic to use diversion routes • Deploy law enforcement to direct traffic at critical locations

LOCAL DETOUR 1/7	GLOBAL DETOUR 2/7	CRITICAL LOCATIONS 3/7	RESPONSE PLAN 4/7	AGENCY CONTACTS 5/7	DMS MESSAGES 6/7	TRAFFIC CONTROL 7/7
---------------------------------	----------------------------------	---------------------------------------	----------------------------------	------------------------------------	---------------------------------	------------------------------------

FREEWAY DIVERSION	POLK COUNTY IOWA	I-35 SOUTHBOUND	FROM: Exit 96 (NE 126th Avenue) TO: Exit 94 (NE 36 th Street)	PLAN 6216 5A/7
------------------------------	-----------------------------	----------------------------	-------------------------------------------------------------------------------------------	---------------------------

CRITICAL CONTACTS

Polk County Communications 515-286-3333	Iowa DOT Statewide TMC 515-237-3300	Iowa State Patrol Comm. Center 800-525-5555	Ankeny Traffic Engineer 515-494-7237	Union Pacific Railroad Company 888-877-7267
--------------------------------------------	----------------------------------------	------------------------------------------------	-----------------------------------------	------------------------------------------------

RESPONSIBILITIES

Polk County Communications	515-286-3333
Coordinate with the incident commander as to whether a diversion route is needed and which one should be implemented. <ul style="list-style-type: none"> Notify Iowa DOT statewide TMC of route implemented, incident specific or maintenance needs, and who the incident commander is. Dispatch County Sheriff, local law enforcement, and fire departments as needed. Inform local municipalities and other jurisdictions that a diversion route is being implemented. Deploy law enforcement to direct traffic at critical locations as needed. 	
<u>Emergency Responders:</u> <ul style="list-style-type: none"> Secure scene. Provide incident information, diversion route recommendations, and towing needs to E911. Minimize impact to traffic. Provide manual traffic control as needed, or as directed by E911 at critical locations 	

Iowa DOT Statewide TMC	515-237-3300
Deploy informational DMS and 511 messages to alert motorists of construction, delays, incidents, closures, etc. and/or directional DMS messaging to direct traffic to the implemented diversion route. <ul style="list-style-type: none"> Monitor incidents and critical locations along the implemented diversion route. Coordinate with Iowa DOT maintenance facilities regarding traffic control needs. Deploy PDMS and Portable CCTV devices as needed for longer duration incidents. Coordinate with local municipalities regarding the modification of signals, signal timing, or stop signs. Coordinate with railroad authority regarding key crossings along the implemented diversion route. 	

Iowa State Patrol Comm. Center	800-525-5555
Dispatch State Patrol.	
<u>On-Scene Incident Commander:</u> <ul style="list-style-type: none"> Secure scene. Notify appropriate communications center of incident location, anticipated duration, affected lanes, and identify the incident commander. Coordinate with the communications center regarding diversion route needs. Minimize impact to traffic through coordination of on-scene traffic control. Ensure overweight and oversize vehicles are parked. When the incident is safely cleared, notify the appropriate communications center that the diversion route is no longer needed. 	

LOCAL DETOUR 1/7	GLOBAL DETOUR 2/7	CRITICAL LOCATIONS 3/7	RESPONSE PLAN 4/7	AGENCY CONTACTS 5/7	DMS MESSAGES 6/7	TRAFFIC CONTROL 7/7
---------------------------------	----------------------------------	---------------------------------------	----------------------------------	------------------------------------	---------------------------------	------------------------------------

Iowa DOT TMC: 515-237-3300 **ENSURE ALL OVERWEIGHT AND OVERSIZE VEHICLES ARE PARKED SAFELY**

FREEWAY DIVERSION	POLK COUNTY IOWA	I-35 SOUTHBOUND	FROM: Exit 96 (NE 126th Avenue) TO: Exit 94 (NE 36 th Street)	PLAN 6216 5B/7
ADDITIONAL CONTACT INFORMATION				

Polk County Communications	
Des Moines Dispatch	515-283-4811

Iowa DOT Statewide TMC	
Iowa DOT Statewide TMC (Toll Free)	888-449-9672
Iowa DOT Maint. Garage – Des Moines	515-265-1614
Union Pacific RR Co.	888-877-7267

Iowa State Patrol Comm. Center	
Iowa State Patrol – District 1	515-725-0010
Iowa State Patrol – District 15	515-281-6176
Iowa State Patrol – District 16	515-281-3879
Iowa State Patrol – Central HQ	515-725-6090

Ankeny Traffic Engineer	
Ankeny Traffic Engineer	515-494-7237

LOCAL DETOUR 1/7	GLOBAL DETOUR 2/7	CRITICAL LOCATIONS 3/7	RESPONSE PLAN 4/7	AGENCY CONTACTS 5/7	DMS MESSAGES 6/7	TRAFFIC CONTROL 7/7
Iowa DOT TMC: 515-237-3300			ENSURE ALL OVERWEIGHT AND OVERSIZE VEHICLES ARE PARKED SAFELY			

FREEWAY DIVERSION	POLK COUNTY IOWA	I-35 SOUTHBOUND	FROM: Exit 96 (NE 126th Avenue) TO: Exit 94 (NE 36 th Street)	PLAN 6216 6/7
DMS MESSAGES				

LOCAL PRIMARY	Sign Location	Page 1	Page 2
	I-35 SB @ IA 210 - (OH)	ROAD CLOSED AT EXIT 96 DETOUR TO 126TH E	ROAD CLOSED AT EXIT 96 PREPARE TO STOP
	I-35 SB @ Ames Abe - (OH)	ROAD CLOSED AT EXIT 94 PREPARE TO STOP	ROAD CLOSED AT EXIT 96 PREPARE TO STOP

LOCAL SECONDARY	Sign Location	Page 1	Page 2
	NO DMS AVAILABLE		

GLOBAL	Sign Location	Page 1	Page 2
	NO DMS AVAILABLE		

LOCAL DETOUR 1/7	GLOBAL DETOUR 2/7	CRITICAL LOCATIONS 3/7	RESPONSE PLAN 4/7	AGENCY CONTACTS 5/7	DMS MESSAGES 6/7	TRAFFIC CONTROL 7/7
---------------------------------	----------------------------------	---------------------------------------	----------------------------------	------------------------------------	---------------------------------	------------------------------------

FREEWAY DIVERSION	POLK COUNTY IOWA	I-35 SOUTHBOUND	FROM: Exit 96 (NE 126th Avenue) TO: Exit 94 (NE 36 th Street)	PLAN 6216 7/7
TRAFFIC CONTROL				

LOCATION	INITIAL ACTION/RESOURCE	EXTENDED ACTION/RESOURCE
-----------------	--------------------------------	---------------------------------

Local Diversion - Primary

SB I-35 Off Ramp to NE 126 th Ave EB	Detour Signing	Monitor location. Manual Traffic Control (as needed/peak periods)
NE 126 th Ave at Union Pacific Railroad Crossing	Detour Signing	Coordinate with UP Railroad and local law enforcement as necessary.
NE 126th Ave EB to NE 46 th St SB	Detour Signing	Manual Traffic Control (as needed/peak periods)
NE 46th St SB to NE 94 th Ave WB	Detour Signing	Manual Traffic Control (as needed/peak periods)
NE 94 th Ave at Union Pacific Railroad Crossing	Detour Signing	Coordinate with UP Railroad and local law enforcement as necessary.
NE 94 th Ave WB to I-35 SB (2 Signals)	Detour Signing	Monitor location

Local Diversion – Secondary

SB I-35 Off Ramp to NE 126th Ave WB	Detour Signing	Manual Traffic Control (as needed/peak periods)
NE 126th Ave WB to US 69/ North Ankeny Blvd SB	Detour Signing	Manual Traffic Control (as needed/peak periods)
US 69/North Ankeny Blvd Between NE 126th Ave & NE 36th St (2 Signals)	Detour Signing	Adjust Signal Timing Manual Traffic Control (as needed/peak periods)
US69/North Ankeny Ave SB to NE 36th St EB	Detour Signing	Manual Traffic Control (as needed/peak periods)
NE 36th St EB Between US 69/ North Ankeny Blvd & I-35 (1 Signal)	Detour Signing	Adjust Signal Timing Manual Traffic Control (as needed/peak periods)
NE 36th St EB to I-35 SB		Monitor location

LOCAL DETOUR 1/7	GLOBAL DETOUR 2/7	CRITICAL LOCATIONS 3/7	RESPONSE PLAN 4/7	AGENCY CONTACTS 5/7	DMS MESSAGES 6/7	TRAFFIC CONTROL 7/7
---------------------------------	----------------------------------	---------------------------------------	----------------------------------	------------------------------------	---------------------------------	------------------------------------

FREEWAY DIVERSION	POLK COUNTY IOWA	I-35 SOUTHBOUND	FROM: Exit 96 (NE 126th Avenue) TO: Exit 94 (NE 36 th Street)	PLAN 6216 7/7
TRAFFIC CONTROL				

Global Diversion

I-35 SB Off Ramp to US 30 EB	Detour Signing	Monitor location
US 30 EB to US 65 SB	Detour Signing	Monitor location
US 65 SB to US 65 SB On Ramp at US 65/IA 330 Interchange	Detour Signing	Monitor location
US 65 Between US 65/IA 330 Interchange and I-80 (1 Signal)	Detour Signing	Adjust Signal Timing Manual Traffic Control (as needed/peak periods)
US 65 SB to I-80 WB	Detour Signing	Monitor location
I-80 WB to I-35 SB	Detour Signing	Monitor location

LOCAL DETOUR 1/7	GLOBAL DETOUR 2/7	CRITICAL LOCATIONS 3/7	RESPONSE PLAN 4/7	AGENCY CONTACTS 5/7	DMS MESSAGES 6/7	TRAFFIC CONTROL 7/7
---------------------------------	----------------------------------	---------------------------------------	----------------------------------	------------------------------------	---------------------------------	------------------------------------