

HENRY COUNTY

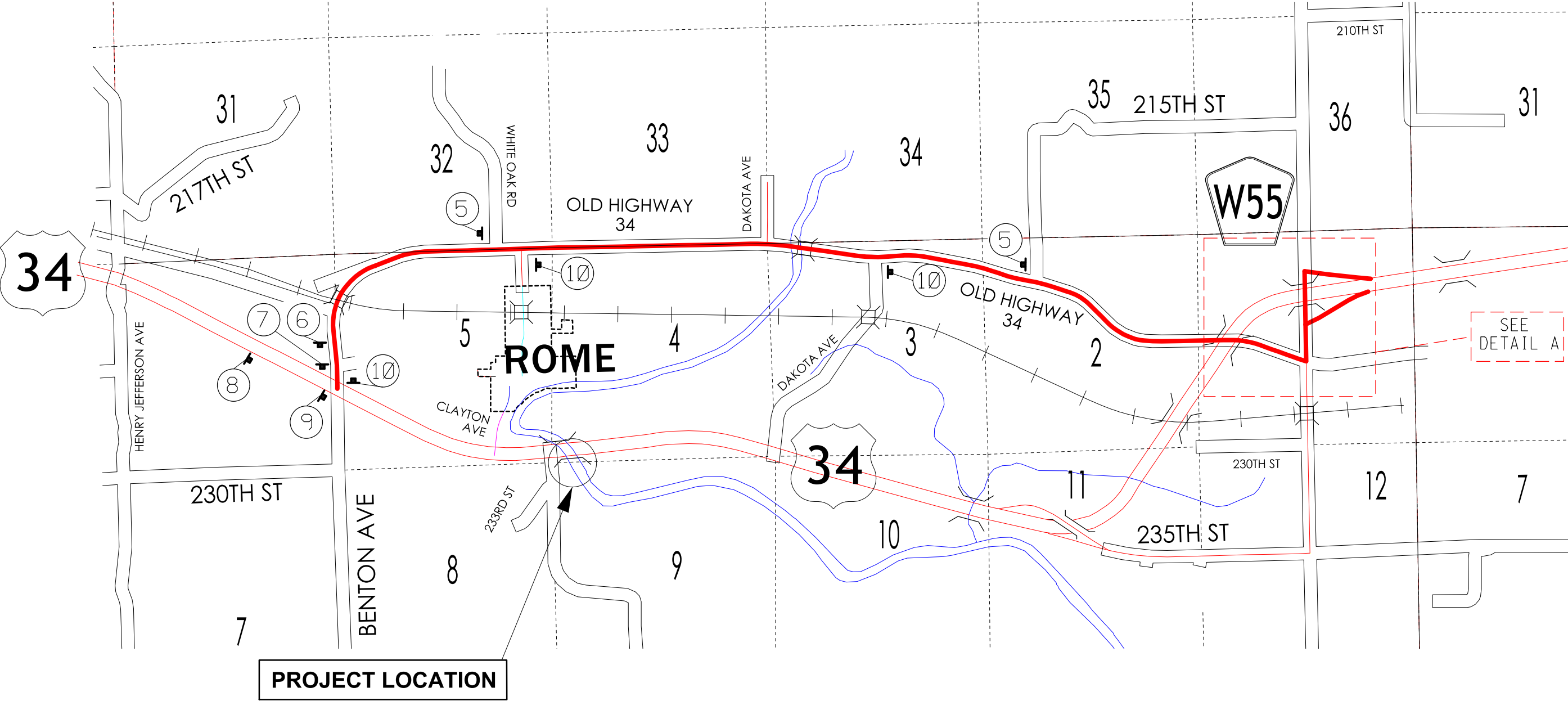

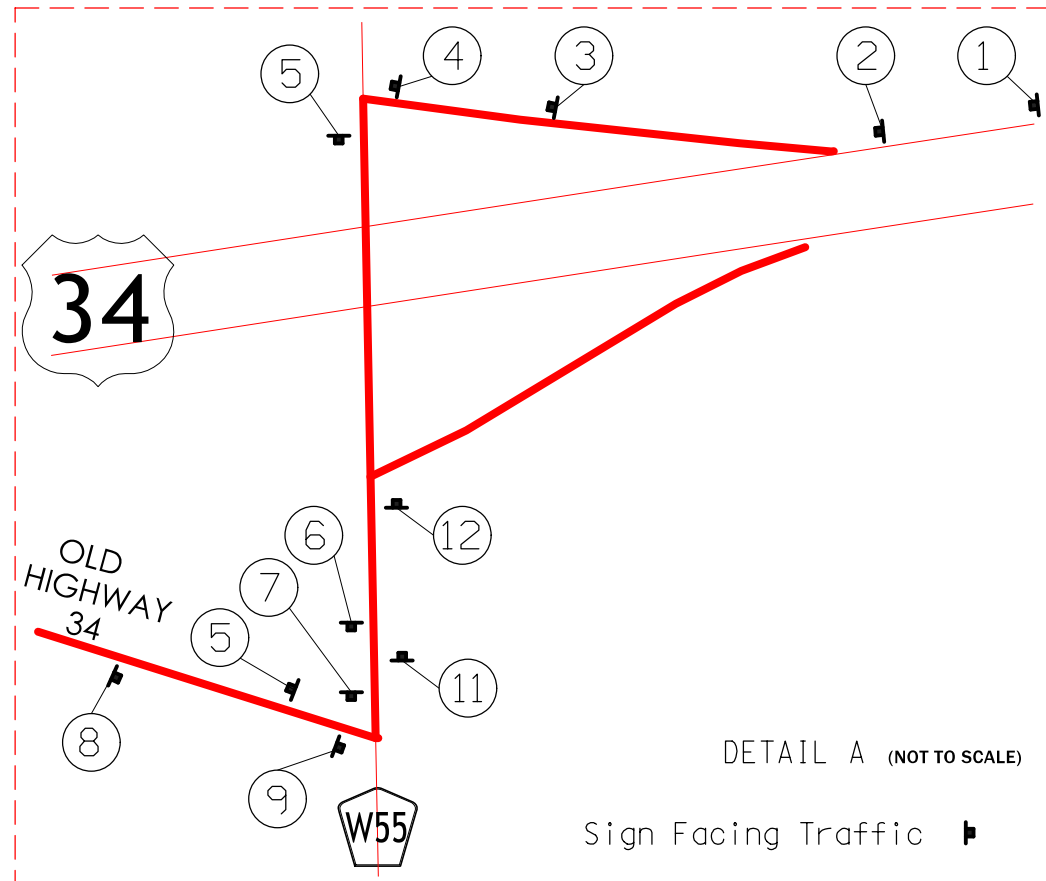

QTY. 1	QTY. 1	QTY. 1	QTY. 1	QTY. 4	QTY. 2	QTY. 2
①	②	③	④	⑤	⑥	⑦
INCIDENT BYPASS TO WEST 34 163 ↗	INCIDENT BYPASS TO WEST 34 163 ↗	INCIDENT BYPASS TO WEST 34 163 ↙	INCIDENT BYPASS TO WEST 34 163 ↙	INCIDENT BYPASS TO WEST 34 163 ↑	INCIDENT BYPASS TO WEST 34 163 ↗	INCIDENT BYPASS TO WEST 34 163 →
QTY. 2	QTY. 2	QTY. 3	QTY. 1	QTY. 1		
⑧	⑨	⑩	⑪	⑫		
INCIDENT BYPASS TO EAST 34 163 ↙	INCIDENT BYPASS TO EAST 34 163 ↙	INCIDENT BYPASS TO EAST 34 163 ↑	INCIDENT BYPASS TO EAST 34 163 ↗	INCIDENT BYPASS TO EAST 34 163 ↗		